

APPENDIX 573, 40-00
ADD 4' APPROXIMATE BENCH
= 4400.0' +/-
= 200' 3' ITEM 1

CONTINUE GRADING NORTH
APPENDIX 582, 400.00
= 400' 0' ITEM 2

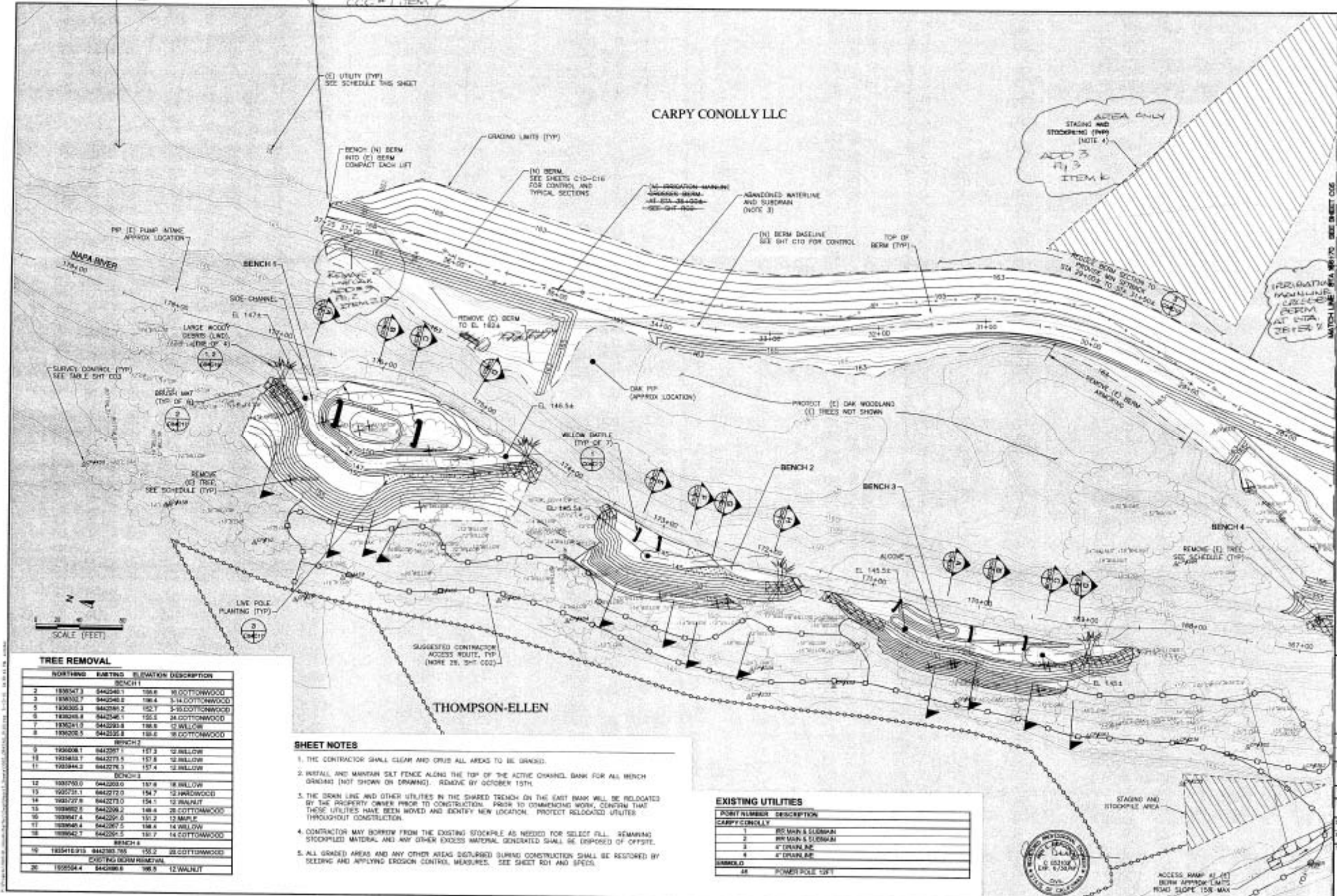

TREE REMOVAL

NORTHING	EASTING	ELEVATION	DESCRIPTION
BENCH 1			
2	1836347.3	8442540.1	188.8 18 COTTONWOOD
3	1836352.7	8442540.2	188.4 3-14 COTTONWOOD
5	1836355.3	8442540.2	185.7 3-15 COTTONWOOD
6	1836348.8	8442546.1	155.3 24 COTTONWOOD
7	1836241.3	8442523.8	188.8 12 WILLOW
8	1836250.5	8442523.8	188.6 18 COTTONWOOD
BENCH 2			
9	1836208.1	8442597.1	157.3 12 WILLOW
10	1836183.7	8442573.5	157.8 12 WILLOW
11	1836146.2	8442578.3	157.4 12 WILLOW
BENCH 3			
12	1836190.0	8442593.0	157.8 18 WILLOW
13	1836231.1	8442572.0	154.7 12 HARDWOOD
14	1836127.8	8442573.0	154.1 12 WALNUT
15	1836182.0	8442566.2	148.4 28 COTTONWOOD
16	1836147.4	8442597.5	151.2 12 MAPLE
17	1836140.4	8442597.5	148.4 14 WILLOW
18	1836142.7	8442597.5	150.7 14 COTTONWOOD
BENCH 4			
19	1835181.0	8442583.5	155.2 20 COTTONWOOD
EXISTING BERM REMOVAL			
20	1836544.4	8442586.8	188.9 12 WALNUT

SHEET NOTES

1. THE CONTRACTOR SHALL CLEAR AND CRUSH ALL AREAS TO BE GRADED.
2. INSTALL AND MAINTAIN SILT FENCE ALONG THE TOP OF THE ACTIVE CHANNEL BANK FOR ALL BENCH GRADINGS (NOT SHOWN ON DRAWING). REMOVE BY OCTOBER 15TH.
3. THE DRAIN LINE AND OTHER UTILITIES IN THE SHARED TRENCH ON THE EAST BANK WILL BE RELOCATED BY THE PROPERTY OWNER PRIOR TO CONSTRUCTION. PRIOR TO COMMENCING WORK, CONFIRM THAT THOSE UTILITIES HAVE BEEN MOVED AND IDENTIFY NEW LOCATION. PROTECT RELOCATED UTILITIES THROUGHOUT CONSTRUCTION.
4. CONTRACTOR MAY BORROW FROM THE EXISTING STOCKPILE AS NEEDED FOR SELECT FILL. REMAINING STOCKPILED MATERIAL AND ANY OTHER EXCESS MATERIAL GENERATED SHALL BE DISPOSED OFF-SITE.
5. ALL GRADED AREAS AND ANY OTHER AREAS DISTURBED DURING CONSTRUCTION SHALL BE RESTORED BY SEEDING AND APPLYING EROSION CONTROL MEASURES. SEE SHEET RD1 AND SPECS.

EXISTING UTILITIES

POINT NUMBER	DESCRIPTION
CARPY CONOLLY	
1	18" WIRN & SLEIGHMAN
2	18" WIRN & SLEIGHMAN
3	4" DRAIN PIPE
4	4" DRAIN PIPE
THOMPSON ELLEN	
48	POWER POLE 120V

PWA
PUBLIC WORKS ASSOCIATION
1195 THIRD ST. SUITE 201
NAPA, CA 94559

GRADING PLAN: STA 166+70 TO STA 179+65

NAPA COUNTY
DEPARTMENT OF PUBLIC WORKS
1195 Third St, Suite 201
Napa, CA 94559

NAPA RIVER RESTORATION
RUTHERFORD REACH 3

DATE: 01/15/2024
DRAWN: J. HANSEN
CHECKED: A. BOURGEOIS
SCALE: AS SHOWN
DATE: STAGED
SHEET: C04

4 of 23

TREE REMOVAL

NORTHING	EASTING	ELEVATION	DESCRIPTION
BENCH 4			
22	193532.67	6442363.9	161.8 3-18 BLACKOAK
23	1935370.49	6442487.9	163.3 38 WALNUT
26	1935349.7	6442386.7	147.1 12 WILLOW
BENCH 5			
26	1935355.6	6442547.8	166.3 2-12 WHITEOAK
27	1935360.1	6442543.9	164.0 35-18 WHITEOAK
28	1935364.3	6442541.0	163.8 12-18 WHITEOAK
29	1935375.5	6442518.8	160.3 36 BLACKOAK
30	1935385.3	6442512.8	160.9 20 BLACKOAK
31	1934888.9	6442507.8	152.0 2-16 WILLOW
32	1934903.1	6442506.8	159.7 16-20 BLACKOAK
33	1934911.3	6442506.3	145.6 16 WILLOW
EXISTING BERM REMOVAL			
34	1934465.0	6443143.3	162.4 12 LIMBOK

SHEET NOTES

1. THE CONTRACTOR SHALL CLEAR AND GRUB ALL AREAS TO BE GRADED.
2. INSTALL AND MAINTAIN SILT FENCE ALONG THE TOP OF THE ACTIVE CHANNEL BANK FOR ALL BENCH GRADING (NOT SHOWN ON DRAWING). REMOVE BY OCTOBER 15TH.
3. THE DRAIN LINE AND OTHER UTILITIES IN THE SHARED TRENCH ON THE EAST BANK WILL BE RELOCATED BY THE PROPERTY OWNER PRIOR TO CONSTRUCTION. PRIOR TO COMMENCING WORK, CONFIRM THAT THESE UTILITIES HAVE BEEN MOVED AND IDENTIFY NEW LOCATION. PROTECT RELOCATED UTILITIES THROUGHOUT CONSTRUCTION.
4. CONTRACTOR MAY BORROW FROM THE EXISTING STOCKPILE AS NEEDED FOR SELECT FILL. REMAINING STOCKPILED MATERIAL AND ANY OTHER EXCESS MATERIAL GENERATED SHALL BE DISPOSED OF OFFSITE.
5. ALL GRADED AREAS AND ANY OTHER AREAS DISTURBED DURING CONSTRUCTION SHALL BE RESTORED BY SEEDING AND APPLYING EROSION CONTROL MEASURES. SEE SHEET R01 AND SPECS.
6. THE "MINIMAL GRADING AREA" BETWEEN THE EXISTING BERM AND THE NEW BERM (ON THE VINEYARD SIDE) IS CONSIDERED PART OF THE PROJECT LIMITS. THIS AREA IS NOT HIGHLIGHTED BECAUSE DESIGN GRADES MATCH EXISTING GRADES. THIS AREA MAY BE USED FOR TEMPORARY STOCKPILING AND EQUIPMENT STAGING DURING CONSTRUCTION.
7. THE "MINIMAL GRADING AREA" SHALL BE CLEARED AND GRUBBED, AND GRADED AS NEEDED TO PROVIDE POSITIVE DRAINAGE TO THE RIVER CHANNEL. SEED AND APPLY EROSION CONTROL MEASURES.

CARPY CONOLLY LLC

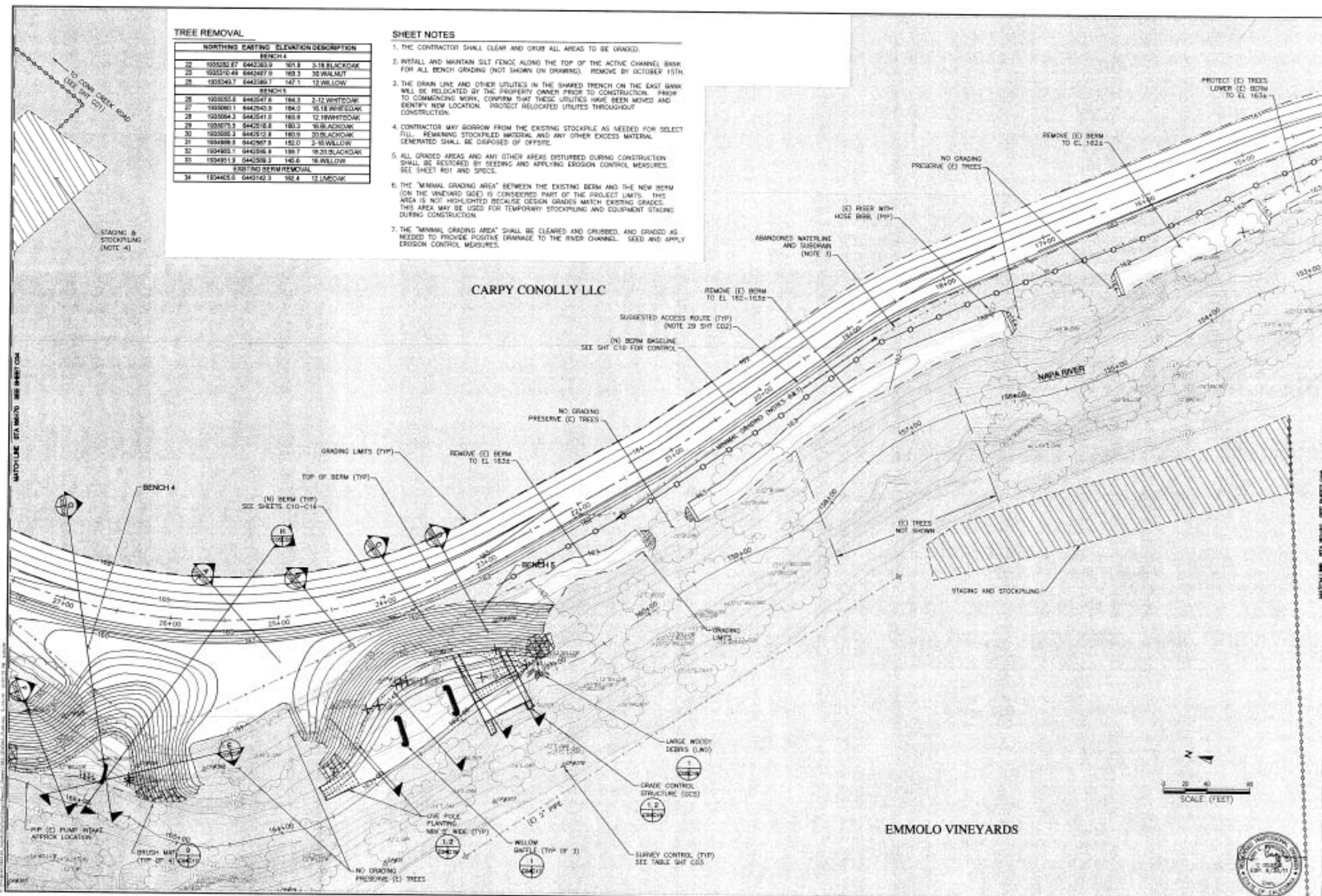

GRADING PLAN: STA 152+82 TO STA 166+70
 NAPA RIVER RESTORATION
 RUTHERFORD REACH 3

NAPA COUNTY
 DEPARTMENT OF PUBLIC WORKS
 1195 Third St, Suite 201
 Napa, CA 94559



APPROVED	
DESIGNED	J. BLAMIRE
DRAWN	B. THOMAS
INCHARGE	A. GONZALEZ
SCALE	AS SHOWN
DATE	08/25/11
SHEET	C05

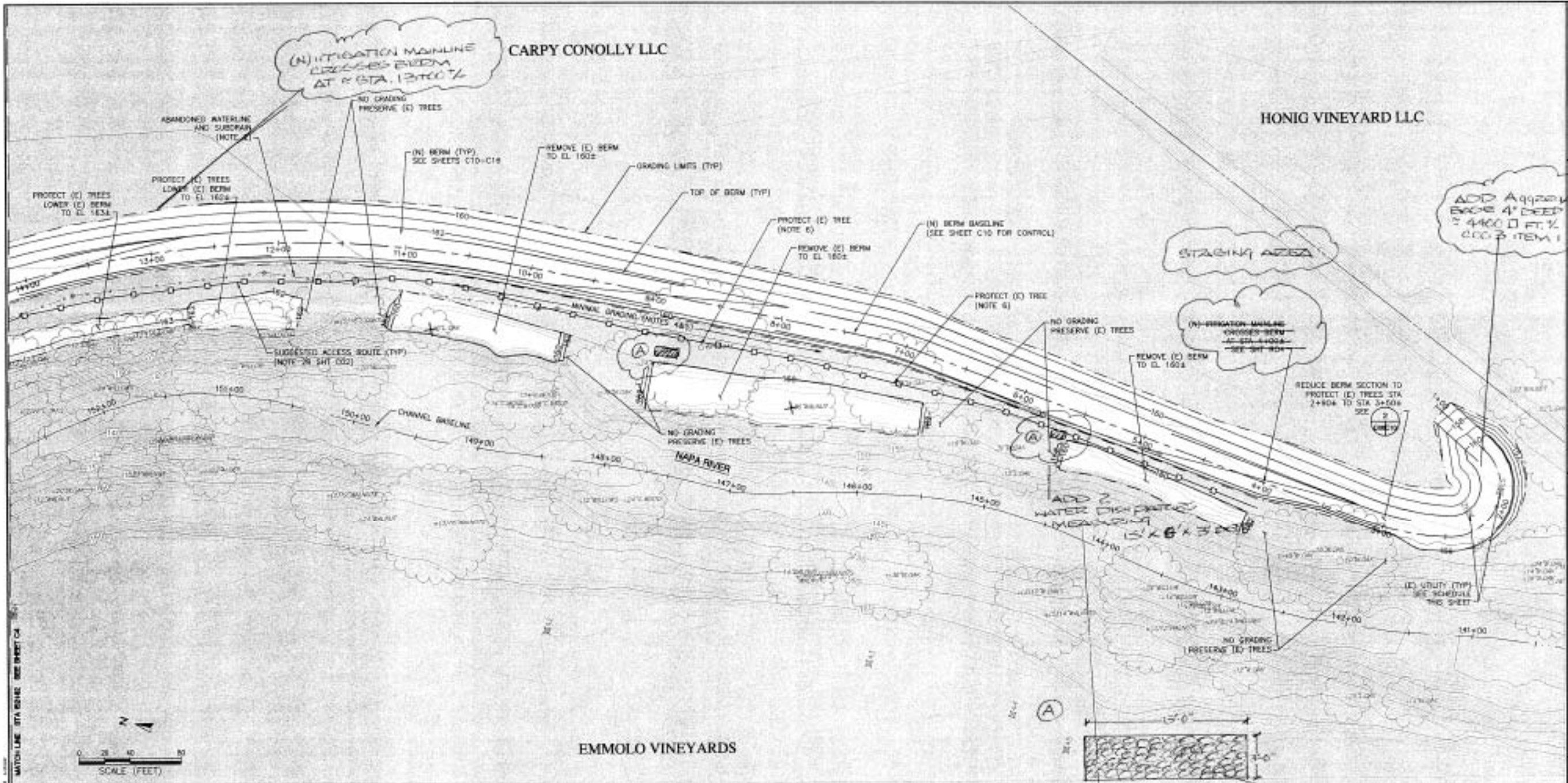

TREE REMOVAL

NORTHING	EASTING	ELEVATION	DESCRIPTION
EXISTING BERM REMOVAL			
35	1894527.3	640331.3	12 LINEDOAK
36	1833733.4	640337.7	30 WALNUT

- SHEET NOTES**
1. THE CONTRACTOR SHALL CLEAR AND GRUB ALL AREAS TO BE GRADED.
 2. THE DRAIN LINE AND OTHER UTILITIES IN THE SHARED TRENCH ON THE EAST BANK WILL BE RELOCATED BY THE PROPERTY OWNER PRIOR TO CONSTRUCTION. PRIOR TO COMMENCING WORK, CONFIRM THAT THESE UTILITIES HAVE BEEN MOVED AND IDENTIFY NEW LOCATION. PROTECT RELOCATED UTILITIES THROUGHOUT CONSTRUCTION.
 3. ALL GRADED AREAS AND ANY OTHER AREAS DISTURBED DURING CONSTRUCTION SHALL BE RESTORED BY SEEDING AND APPLYING EROSION CONTROL MEASURES. SEE SHEET R01 AND SPECS.
 4. THE "MINIMAL GRADING AREA" BETWEEN THE EXISTING BERM AND THE NEW BERM (ON THE VINEYARD SIDE) IS CONSIDERED PART OF THE PROJECT LIMITS. THIS AREA IS NOT HIGHLIGHTED BECAUSE DESIGN GRADES MATCH EXISTING GRADES. THIS AREA MAY BE USED FOR TEMPORARY STOCKPILING AND EQUIPMENT STAGING DURING CONSTRUCTION.
 5. THE "MINIMAL GRADING AREA" SHALL BE CLEARED AND GRUBBED, AND GRADED AS NEEDED TO PROVIDE POSITIVE DRAINAGE TO THE RIVER CHANNEL. SEED AND APPLY EROSION CONTROL MEASURES.
 6. EXERCISE EXTREME CAUTION TO PROTECT THE WHITE OAKS ADJACENT TO THE NEW BERM. CAREFULLY POTHOLE TO EXPOSE TREE ROOTS WITHIN THE BERM FOOTPRINT. TRIM SMALLER ROOTS PER THE SPECIFICATIONS. DO NOT TRIM ANY TREE ROOTS ARE GREATER THAN 3" AND/OR WITHIN 18" OF EXISTING GRADE. NOTIFY THE OWNER'S REPRESENTATIVE IMMEDIATELY IF THE ROOT SYSTEM MAY BE DAMAGED BY BERM CONSTRUCTION. THE OWNER'S REPRESENTATIVE MAY OPT TO MODIFY THE BERM DIMENSIONS TO PROTECT THE ROOT SYSTEM FROM DAMAGE.

EXISTING UTILITIES

POINT NUMBER	DESCRIPTION
CARPY CONOLLY	
28	SHARED TRENCH SPRINKLER REGISTRATION LATERALS
28	SHARED TRENCH SPRINKLER REGISTRATION LATERALS
28	RIVER WEIR SIDE

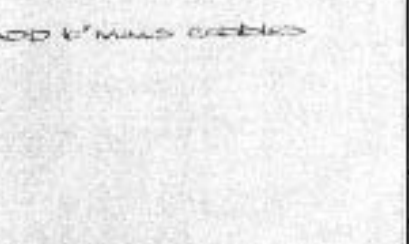
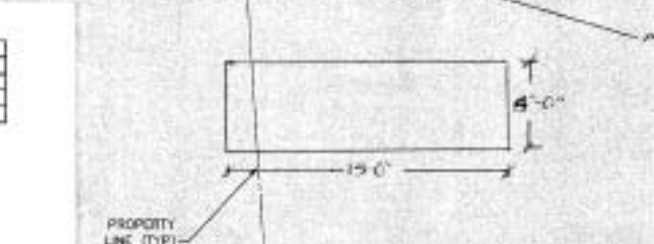



APPROVED	
DESIGNED	R. BROWN 1/2/2007
DRAWN	A. TAMARA
RECHECKED	A. BOBROWICZ 02/12/07
SCALE	AS SHOWN
DATE	02/12/07
SHEET	

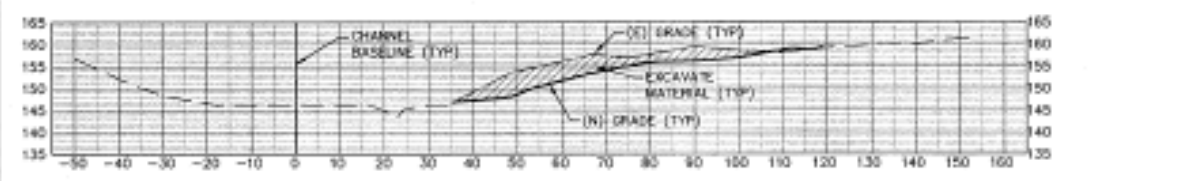

A
 BENCH 1
 SECTION 176+69 SCALE: 1" = 20'

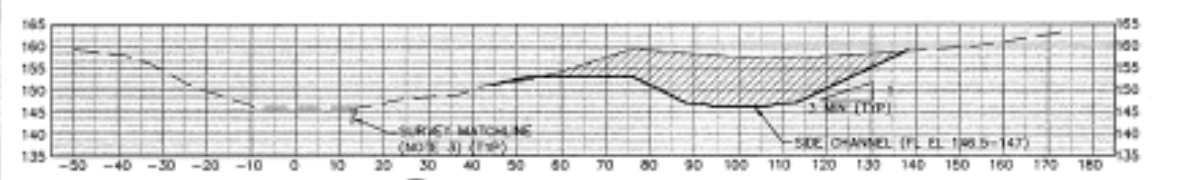

B
 BENCH 1
 SECTION 176+06 SCALE: 1" = 20'

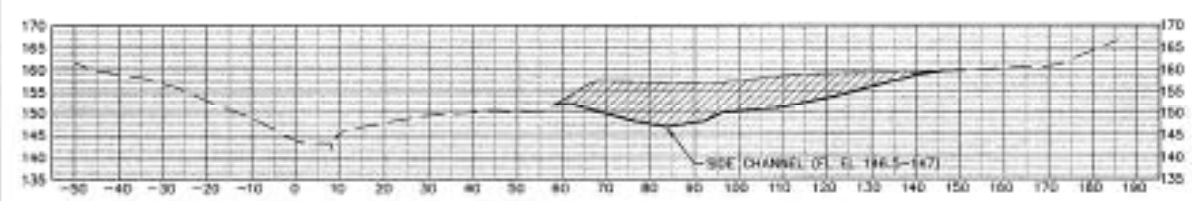

C
 BENCH 1
 SECTION 175+74 SCALE: 1" = 20'

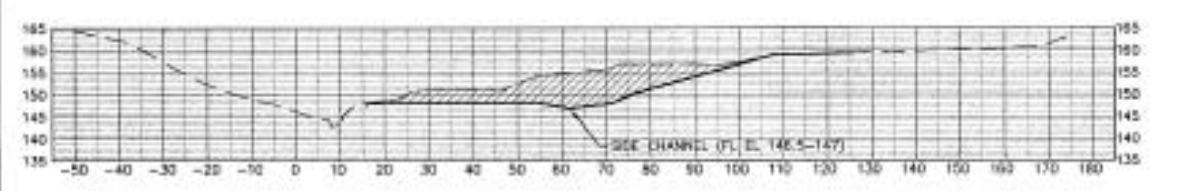

D
 BENCH 1
 SECTION 175+13 SCALE: 1" = 20'

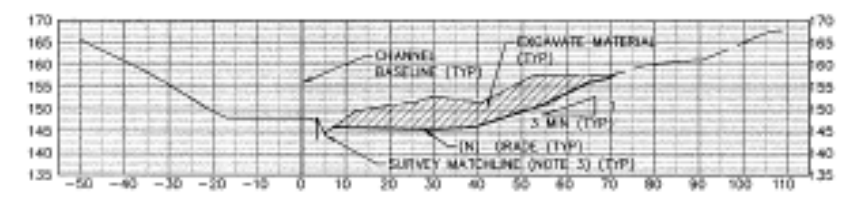

E
 BENCH 2
 SECTION 173+22 SCALE: 1" = 20'

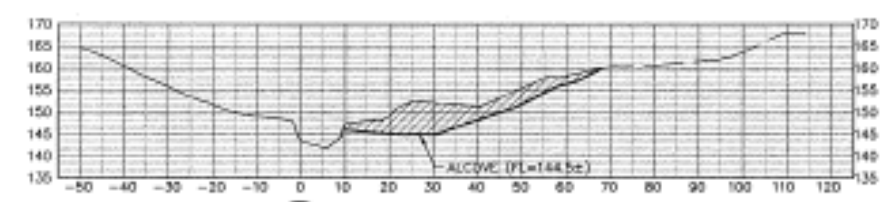

F
 BENCH 2
 SECTION 172+75 SCALE: 1" = 20'

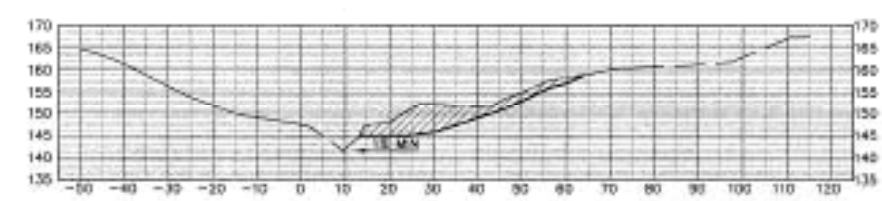

G
 BENCH 2
 SECTION 172+50 SCALE: 1" = 20'

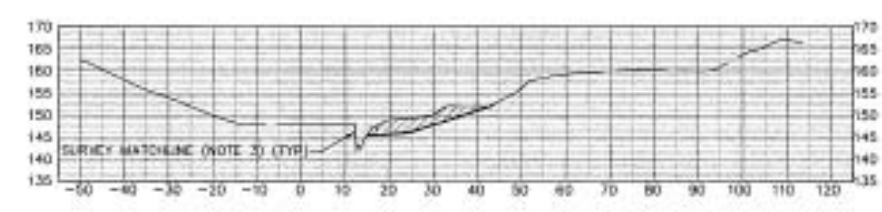

H
 BENCH 2
 SECTION 171+96 SCALE: 1" = 20'

NOTES:

1. SECTIONS ARE SHOWN LOOKING DOWNSTREAM. STATION 0 IS THE CHANNEL BASELINE, SEE SHEET C02 FOR CONTROL TABLE.
2. THE ACCURACY OF TOPOGRAPHIC DATA WITHIN THE ACTIVE CHANNEL IS LIMITED. THE GROUND SURVEY GENERALLY EXTENDS DOWN THE CHANNEL BANK, BUT NOT ACROSS THE CHANNEL. LEIAR DATA FOR THE CHANNEL DOES NOT EXTEND BELOW THE WATER SURFACE AT THE TIME OF THE SURVEY.
3. AT SOME LOCATIONS THE MATCHLINE BETWEEN THE GROUND SURVEY AND LEIAR TOPOGRAPHIC DATA DOES NOT ALIGN VERTICALLY. ALL AVAILABLE DATA IS SHOWN FOR COMPLETENESS. THE GROUND SURVEY DATA (ON THE BENCH SIDE) IS A MORE ACCURATE REPRESENTATION OF ACTUAL CONDITIONS.





APPROVED:	
DESIGNED:	A. SHANK J. BONDERS
DRAWN:	S. TAMURA
CHECKED:	A. BONDERS S. TAMURA
SCALE:	AS SHOWN
DATE:	8/20/20
SHEET:	C08

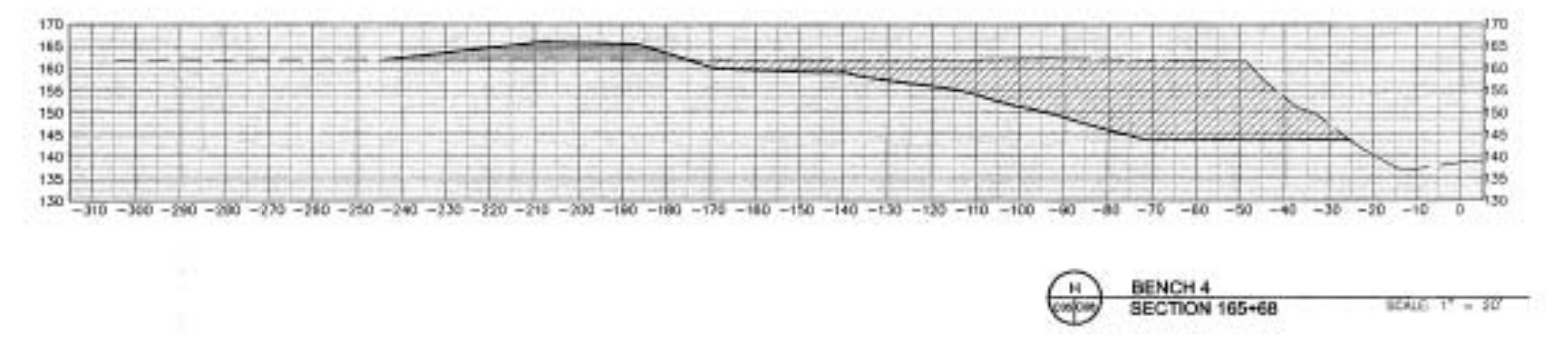
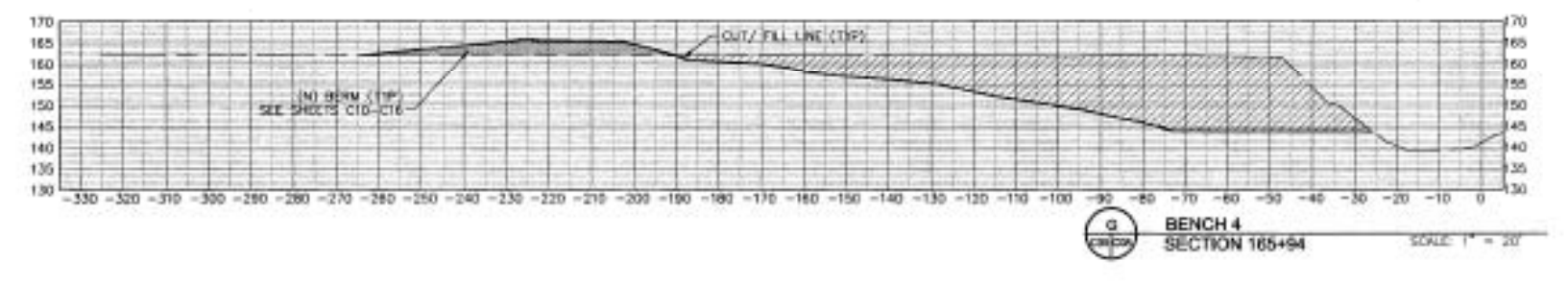
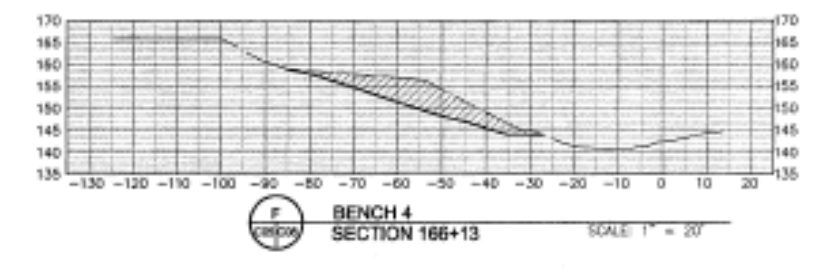
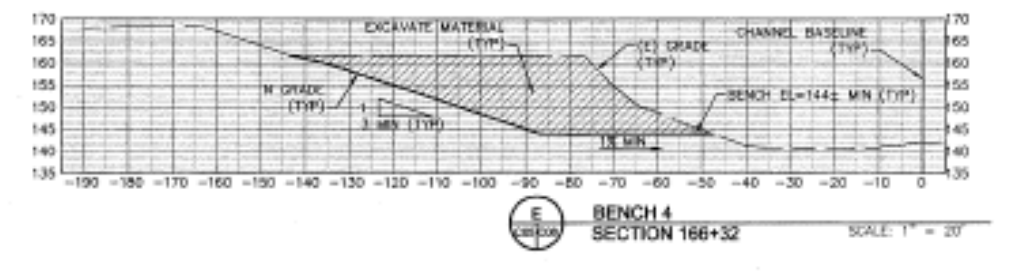
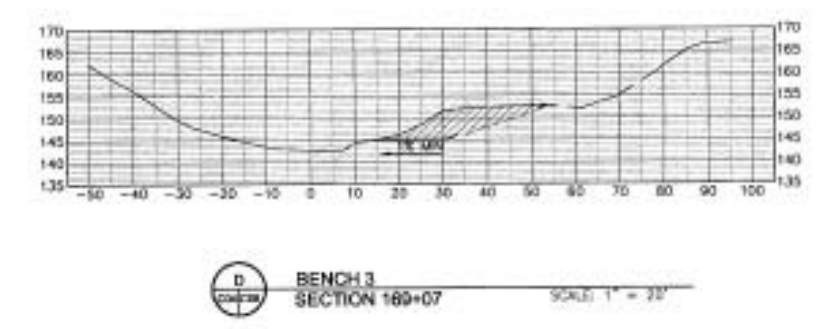
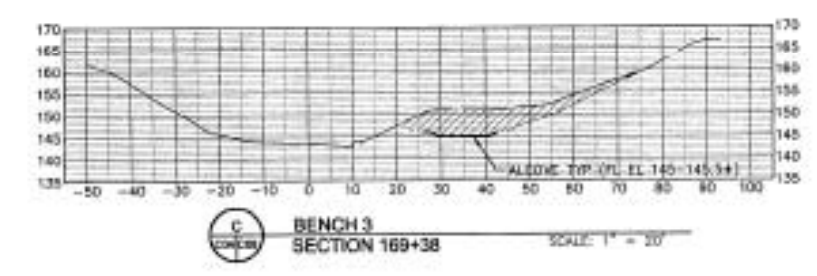
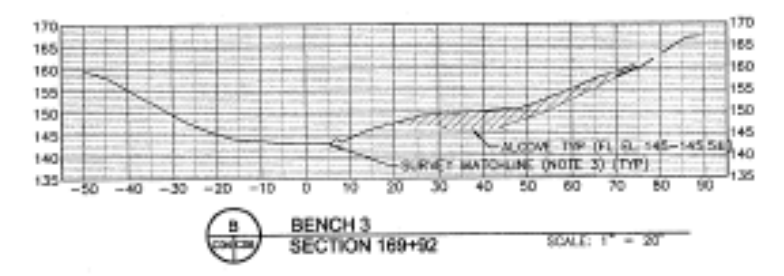
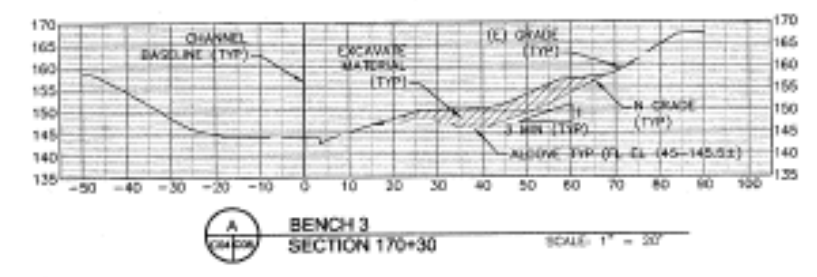

- NOTES:**
1. SECTIONS ARE SHOWN LOOKING DOWNSTREAM. STATION 0 IS THE CHANNEL BASELINE. SEE SHEET C02 FOR CONTROL TABLE.
 2. THE ACCURACY OF TOPOGRAPHIC DATA WHEN THE ACTIVE CHANNEL IS LIMITED. THE GROUND SURVEY GENERALLY EXTENDS DOWN THE CHANNEL BANK, BUT NOT ACROSS THE CHANNEL. UTM DATA FOR THE CHANNEL DOES NOT EXTEND BELOW THE WATER SURFACE AT THE TIME OF THE SURVEY.
 3. AT SOME LOCATIONS THE MATCHLINE BETWEEN THE GROUND SURVEY AND UTM TOPOGRAPHIC DATA DOES NOT ALIGN VERTICALLY. ALL AVAILABLE DATA IS SHOWN FOR COMPLETENESS. THE GROUND SURVEY DATA (ON THE BENCH SIDE) IS A MORE ACCURATE REPRESENTATION OF ACTUAL CONDITIONS.



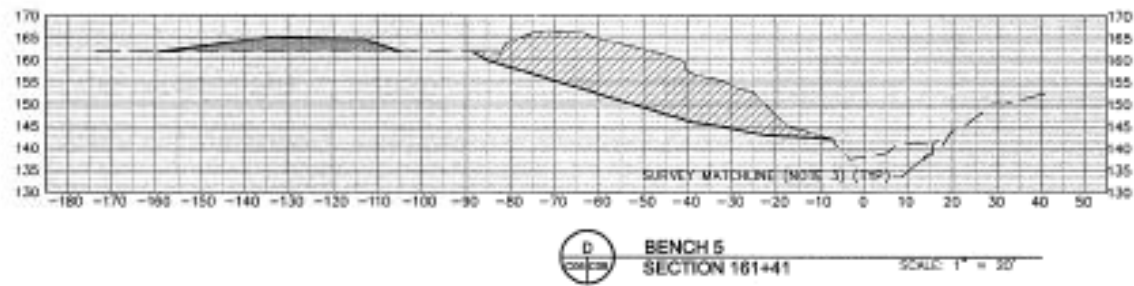
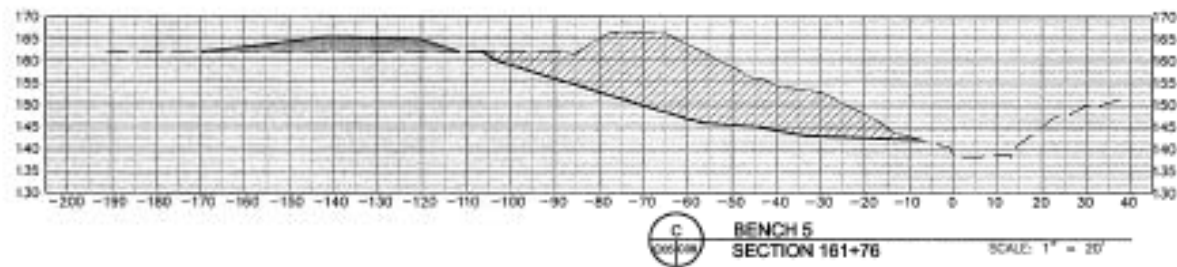
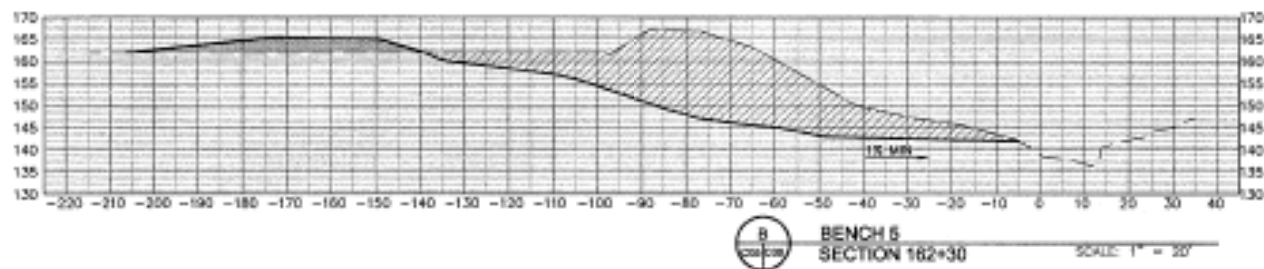
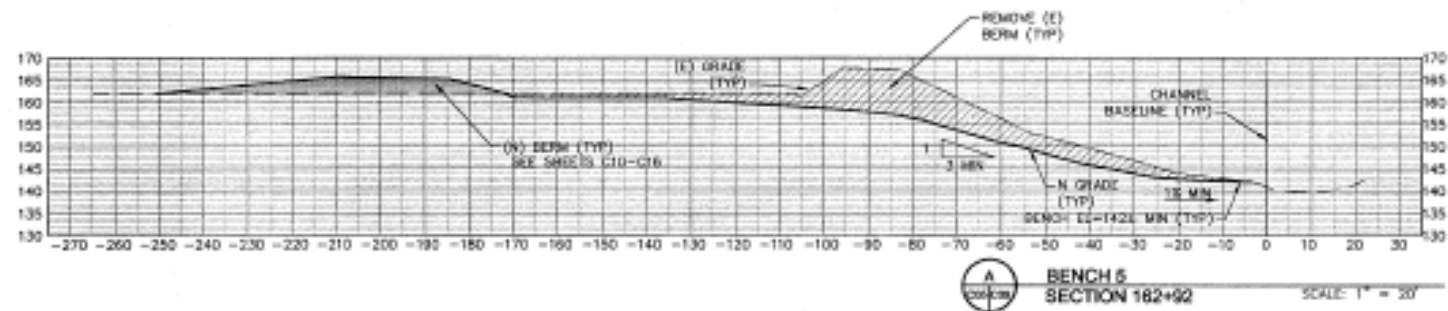

NOTES:

1. SECTIONS ARE SHOWN LOOKING DOWNSTREAM. STATION 0 IS THE CHANNEL BASELINE. SEE SHEET C02 FOR CONTROL TABLE.
2. THE ACCURACY OF TOPOGRAPHIC DATA WITHIN THE ACTIVE CHANNEL IS LIMITED. THE GROUND SURVEY GENERALLY EXTENDS DOWN THE CHANNEL BANK, BUT NOT ACROSS THE CHANNEL. LIDAR DATA FOR THE CHANNEL DOES NOT BELOW THE WATER SURFACE AT THE TIME OF THE SURVEY.
3. AT SOME LOCATIONS THE MATCHLINE BETWEEN THE GROUND SURVEY AND LIDAR TOPOGRAPHIC DATA DOES NOT ALIGN VERTICALLY. ALL AVAILABLE DATA IS SHOWN FOR COMPLETENESS. THE GROUND SURVEY DATA (ON THE BENCH SIDE) IS A MORE ACCURATE REPRESENTATION OF ACTUAL CONDITIONS.



GRADING SECTIONS BENCH 5
NAPA RIVER RESTORATION
RUTHERFORD REACH 3

NAPA COUNTY
DEPARTMENT OF PUBLIC WORKS
1195 Third St, Suite 201
Napa, CA 94559



APPROVED	
DESIGNED	R. BROWN J. BOMBARDI
DRAWN	S. TANAKA
INCHARGE	A. BORGONOVO C0910
SCALE	AS SHOWN
OWN	W. GARDNER
SHEET	

C09

POINT	STATION	NORTHING	EASTING
CPI	1+00	1033241.886	6443427.232
CP2	21+00	1033261.638	6443213.820

NUMBER	BEGIN STATION	BEGIN EASTING	BEGIN NORTHING	LINE BEARING	LINE DISTANCE	CURVE DISTANCE	CURVE RADIUS	DELTA ANGLE
L6	1+00	6443427.7	1033241.9	S28° 52' 04"W	51.25			
CR	1+51.25	6443403.0	1033197.0			93.00	36.56	120° 51' 51"
CR	2+45.36	6443393.2	1033206.8			60.00	280.00	20° 02' 20"
L7	3+15.61	6443355.9	1033275.1	N3° 10' 51"W	377.33			
CR	6+02.94	6443374.7	1033043.4			32.20	280.00	9° 13' 30"
L8	7+24.94	6443375.2	1033081.0	N1° 50' 33"W	293.70			
CR	10+18.32	6443386.2	1033075.2			493.00	010.00	34° 42' 48"
L5	15+08.30	6443256.4	1034131.5	S00° 41' 42"W	308.89			
CR	18+15.39	6443023.5	1034676.9			150.27	616.00	11° 15' 52"
L4	19+15.06	6443054.5	1034749.5	N40° 50' 23"W	196.76			
CR	21+12.44	6442906.1	1034570.0			172.69	1808.70	0° 30' 31"
CR	22+04.54	6442587.5	1035082.4			563.43	626.83	64° 02' 30"
L3	27+07.87	6442555.1	1035480.3	N11° 34' 44"E	106.20			
CR	29+08.17	6442591.3	1035645.9			146.47	296.82	20° 28' 04"
L2	31+17.84	6442583.1	1035783.6	N07° 53' 20"W	143.72			
CR	32+08.36	6442539.8	1035827.4			190.85	407.06	21° 12' 44"
L1	34+08.40	6442517.2	1035935.0	N2° 17' 24"E	208.40			

BERM STATION	PROPOSED ELEVATION
1+00	156.2
1+13	157.2
1+15	157.5
1+23	158.5
1+28	158.5
1+33	158.0
1+38	158.0
1+43	158.0
1+48	158.0
4+13	155.0
8+08	155.8
9+02	155.0
11+08	152.2
13+04	153.0
15+08	153.2
18+12	154.0
20+12	154.2
22+08	155.0
25+45	155.8
27+02	156.0
30+18	156.2
32+04	157.0
34+05	157.2
37+07	158.0

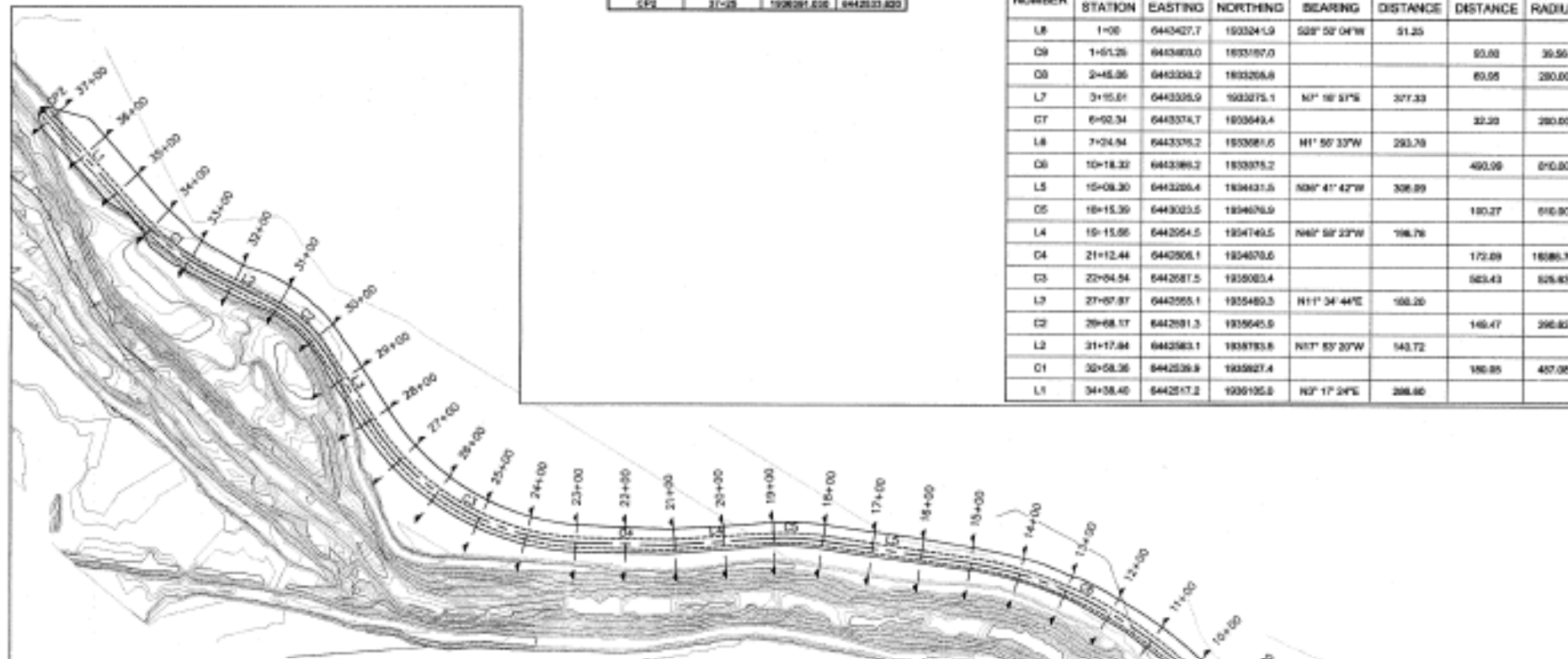

BERM GRADING SECTIONS KEY MAP SCALE: 1" = 150'

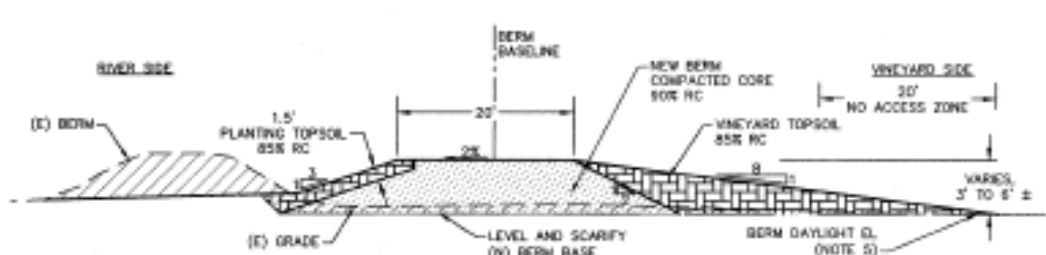

1 NEW BERM TYPICAL SECTION SCALE: 1" = 10'

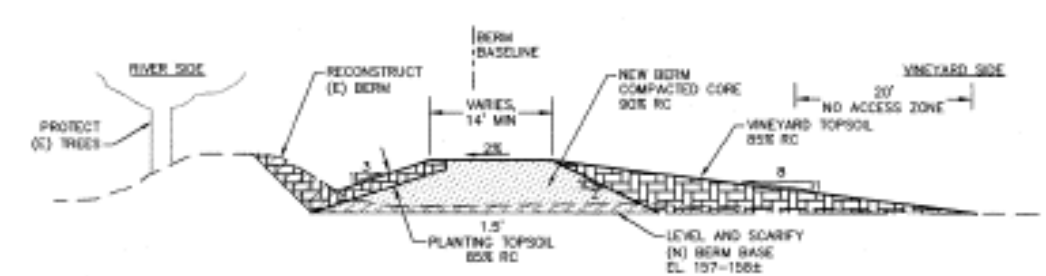

2 NEW BERM (MODIFIED AT (E) TREES) STA 2+50 TO STA 3+50 SCALE: 1" = 10' (NOTE 3)

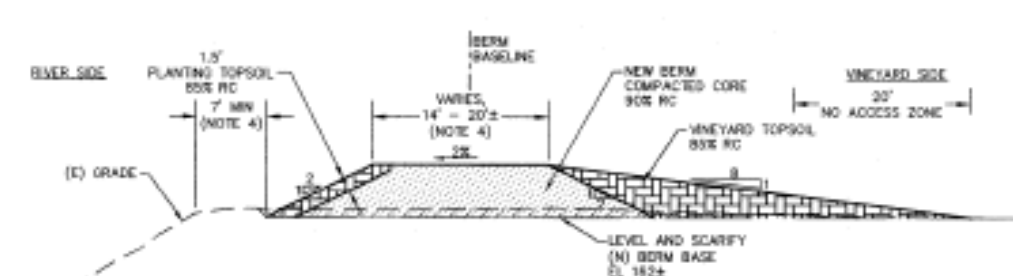

3 NEW BERM (AT TOP OF CHANNEL BANK) STA 29+50 TO STA 31+20 SCALE: 1" = 10' (NOTE 4)

- SHEET NOTES**
- BERM SECTIONS ARE SHOWN LOOKING UPSTREAM (UPSTREAM).
 - SEE SHEETS C11 TO C16 FOR BERM GRADING SECTIONS.
 - SECTION 2 APPLIES WHERE THE EXISTING BERM IS TO REMAIN FOR TREE PROTECTION. DO NOT EXCAVATE WITHIN THE DROPLINE OF THE TREE(S) TO REMAIN. REDUCE TOP WIDTH OF BERM CORE (TO 14 FEET OR WIDER) AS NEEDED TO PROTECT TREE ROOTS. (TRANSITION FROM THIS MODIFIED SECTION TO TYPICAL SECTION OVER APPROX 40-FOOT LENGTH.)
 - SECTION 3 APPLIES WHERE THE NEW BERM IS CLOSE TO THE TOP OF RIVER BANK. REDUCE TOP WIDTH OF BERM CORE (TO 12 FEET OR WIDER) AS NEEDED TO ENSURE THE RIVERSIDE SIDE OF BERM IS 7FT MIN FROM THE TOP OF RIVER BANK.
 - OVEREXCAVATE WITHIN THE FOOTPRINT OF THE (N) BERM CORE TO THE BERM DAYLIGHT ELEVATION. PLACE FILL FOR NEW BERM IN UNIFORM LIFTS.
 - DO NOT USE THE "NO ACCESS ZONE" AS AN ACCESS ROUTE. USE FOR FILL PLACEMENT AND TEMPORARY STOCKPILING ONLY. SEE SPECS FOR OTHER SCHEDULE CONSTRAINTS.

DESIGNED BY: **PWA**
 P. WILLIAMS & ASSOCIATES, LLP
 ENGINEERS/ARCHITECTS/PLANNERS
 1000 CALIFORNIA STREET, SUITE 200
 OAKLAND, CALIFORNIA 94612

PROJECT: **NAPA RIVER RESTORATION RUTHERFORD REACH 3**

DATE: 01/2019

SCALE: AS SHOWN

SHEET: C10

10 of 23

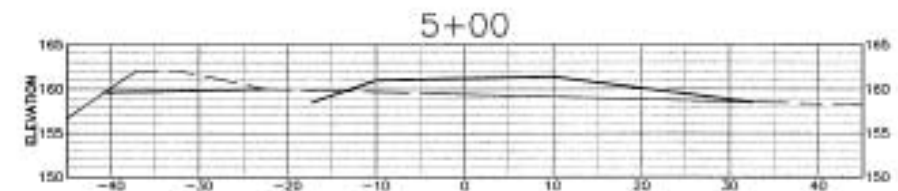
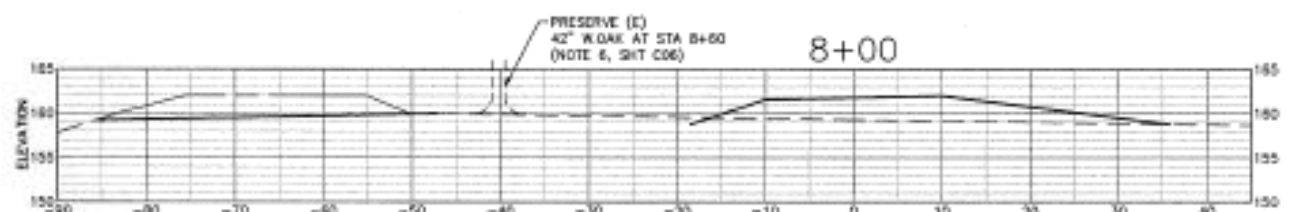
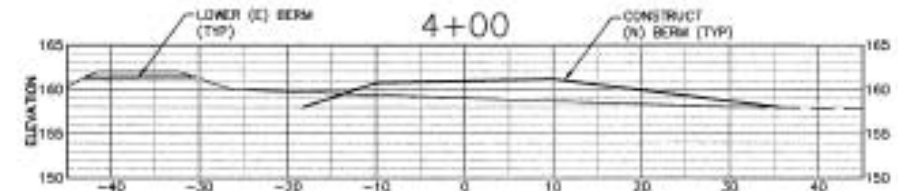
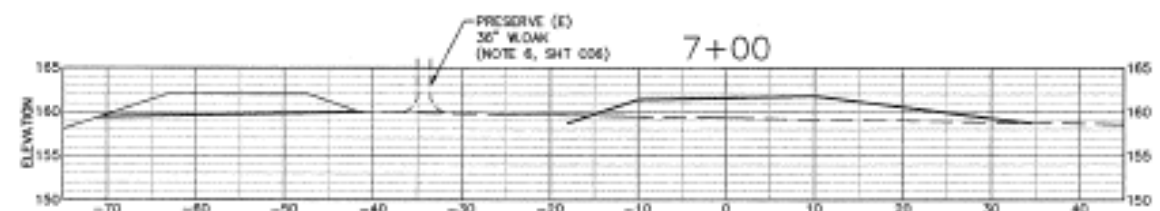
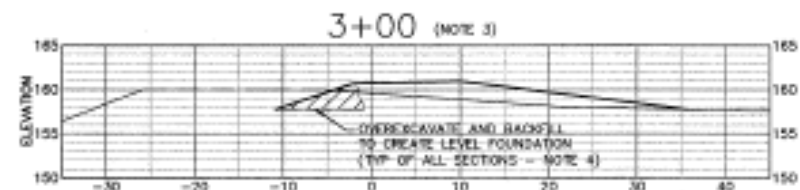
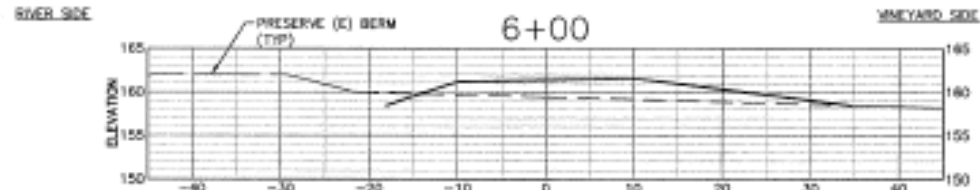
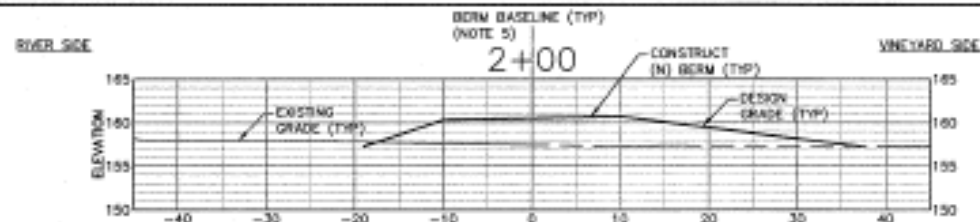

SHEET NOTES

1. SCALE FOR ALL GRADING SECTIONS IS 1"=10'.
2. SEE SHEET C10 FOR TYPICAL SECTIONS.
3. TYPICAL SECTION MODIFIED AT (C) TREES APPLIES TO STA 2+80 TO 3+50. SEE DETAIL 2, SHEET C10.
4. OVEREXCAVATE AS NEEDED TO CREATE LEVEL BERM FOUNDATION. SUBGRADE LIMITS NOT SHOWN ON THIS SHEET. SEE TYPICAL SECTIONS, SHEET C10.
5. STATION 0 ON THE CROSS-SECTION ALIGNS WITH THE (N) BERM BASELINE.



GRADING SECTIONS:
BERM STA 2+00 TO STA 8+00
PROJECT:
NAPA RIVER RESTORATION
RUTHERFORD REACH 3

PREPARED FOR:
NAPA COUNTY
DEPARTMENT OF PUBLIC WORKS
1195 Third St, Suite 201
Napa, CA 94559



DESIGNED	R. BROWN
CHECKED	J. ALVARADO
IN CHARGE	R. STELLER
PROJECT MANAGER	RICHARD L. BORDENCO
SCALE	AS SHOWN
DATE	11/20/03
SHEET	

C11

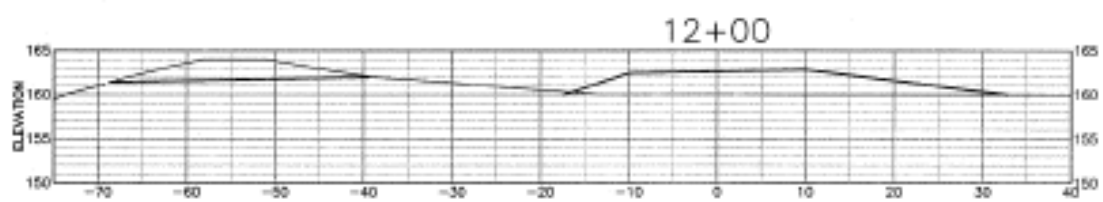
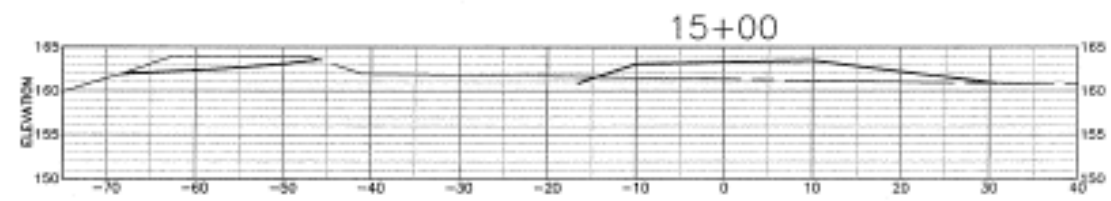
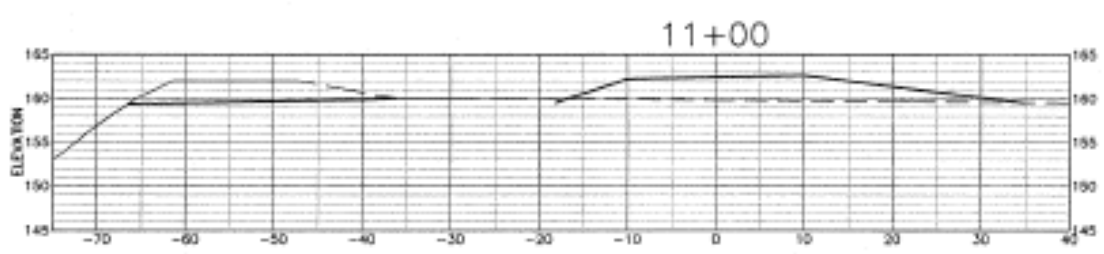
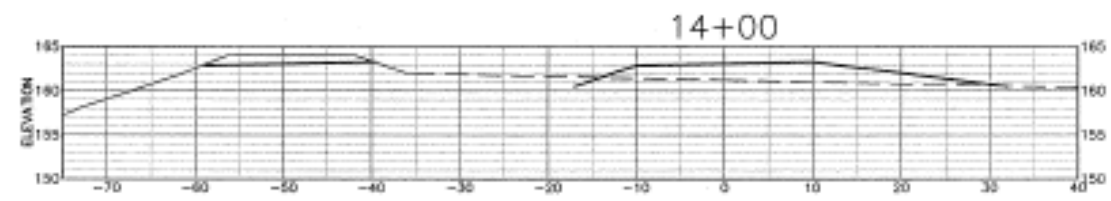
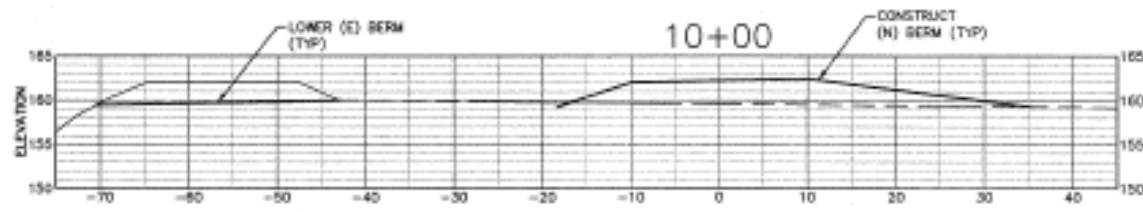
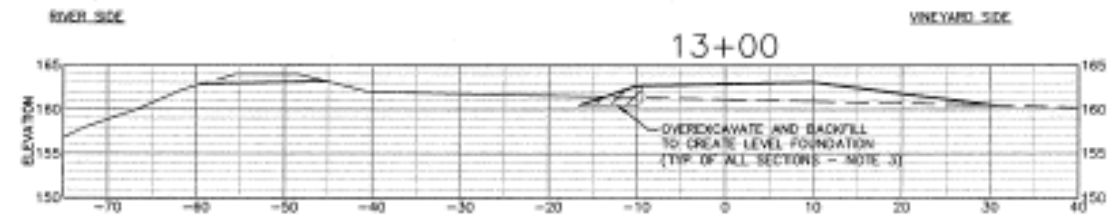
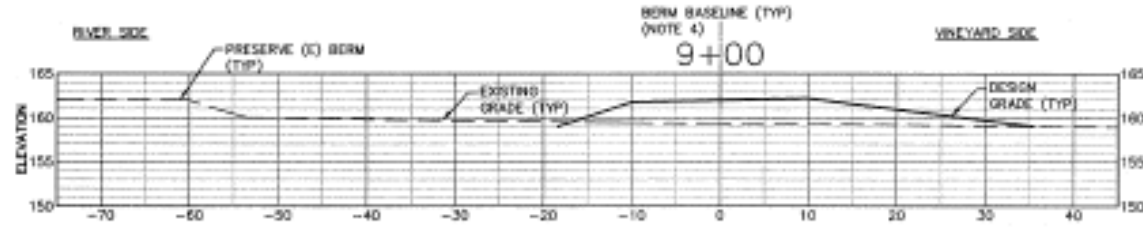

SHEET NOTES

1. SCALE FOR ALL GRADING SECTIONS IS 1"=10'.
2. SEE SHEET C10 FOR TYPICAL SECTIONS.
3. OVEREXCAVATE AS NEEDED TO CREATE LEVEL BERM FOUNDATION. SUBGRADE LIMITS NOT SHOWN ON THIS SHEET. SEE TYPICAL SECTIONS, SHEET C10.
4. STATION 0 ON THE CROSS-SECTION ALIGNS WITH THE (N) BERM BASELINE.



PREPARED BY: PWA
 SHEET TITLE: GRADING SECTIONS:
 BERM STA 9+00 TO STA 15+00
 PROJECT: NAPA RIVER RESTORATION
 RUTHERFORD REACH 3

NAPA COUNTY
 DEPARTMENT OF PUBLIC WORKS
 1195 Third St, Suite 201
 Napa, CA 94559



APPROVED:	
DESIGNED:	R. BROWN J. BLOMBERG
DRAWN:	BLT/BLP
PROJECT:	A. BLOMBERG (C10/C)
SCALE:	AS SHOWN
DATE:	07/20/10
SHEET:	

C12

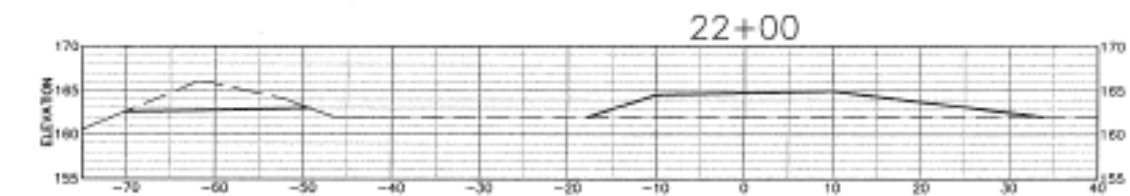
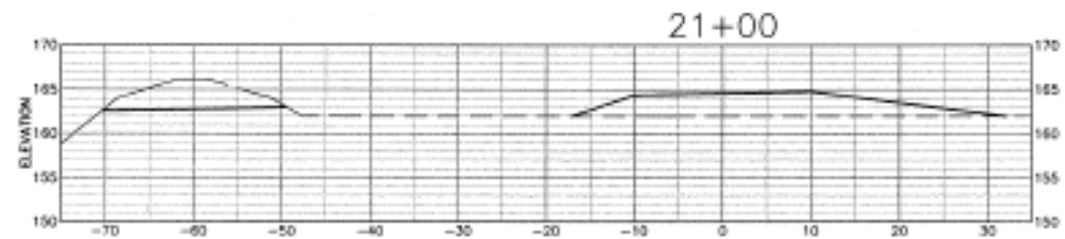
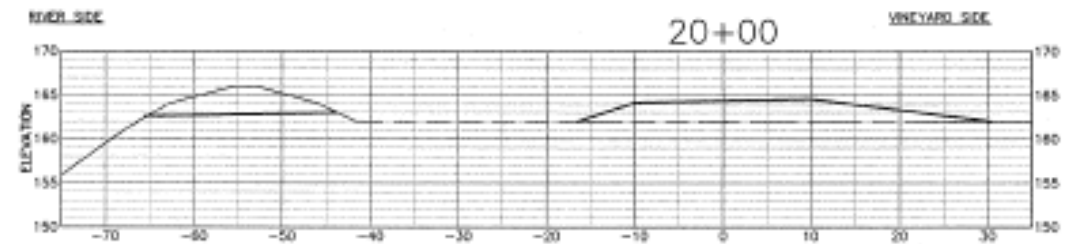
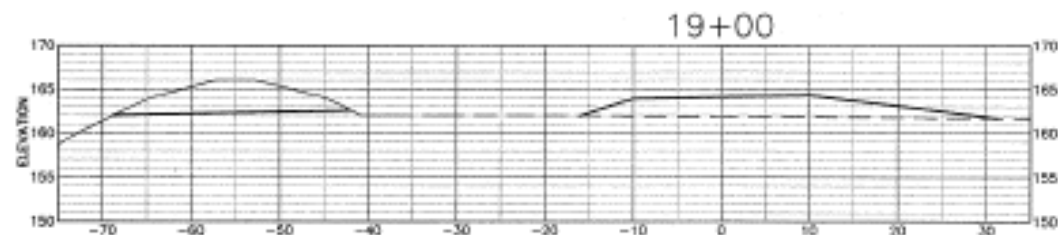
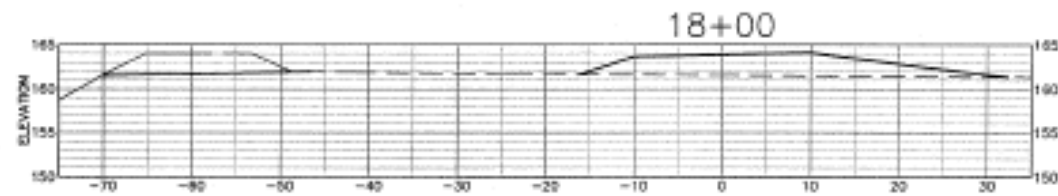
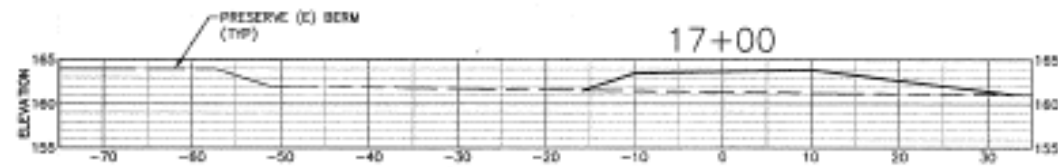
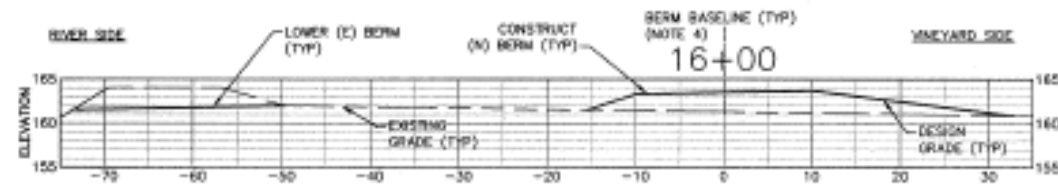

SHEET NOTES

1. SCALE FOR ALL GRADING SECTIONS IS 1"=10'.
2. SEE SHEET C10 FOR TYPICAL SECTIONS.
3. OVERCUT AS NEEDED TO CREATE LEVEL BERM FOUNDATION. SUBGRADE LIMITS NOT SHOWN ON THIS SHEET. SEE TYPICAL SECTIONS, SHEET C10.
4. STATION 0 ON THE CROSS-SECTION ALIGNS WITH THE (N) BERM BASELINE.



GRADING SECTIONS:
BERM STA 16+00 TO STA 22+00
PROJECT:
NAPA RIVER RESTORATION
RUTHERFORD REACH 3

NAPA COUNTY
DEPARTMENT OF PUBLIC WORKS
1195 Third St, Suite 201
Napa, CA 94559



APPROVED	
DESIGNED	R. BROWN J. BLOMBERG
DRAWN	E. STOLLER
INCHARGE	A. BISHOPCHIO (CHECK)
SCALE	AS SHOWN
DATE	01/20/10
SHEET	

C13

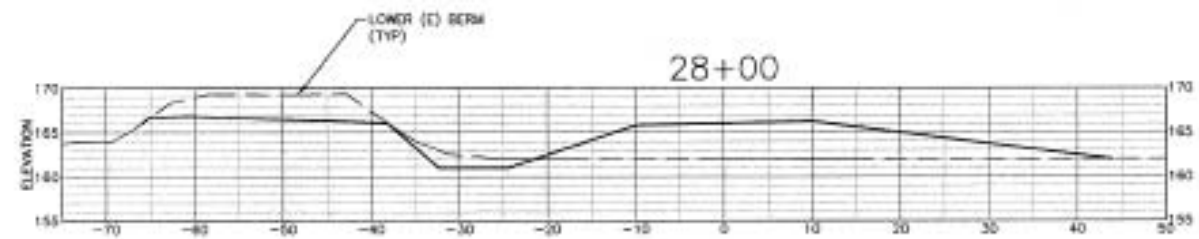
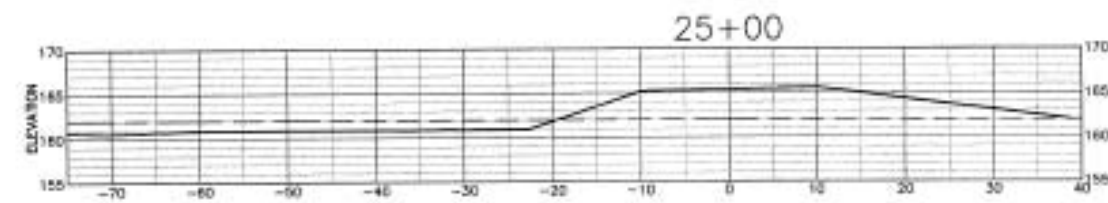
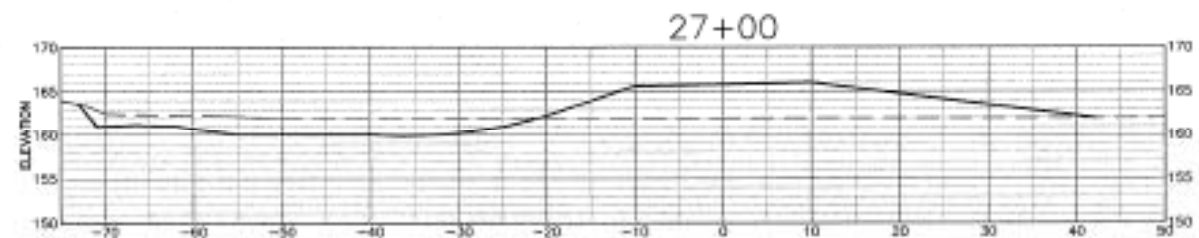
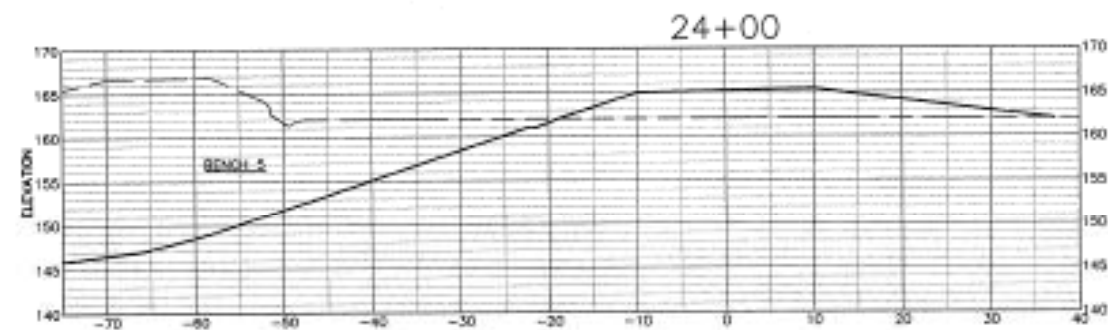
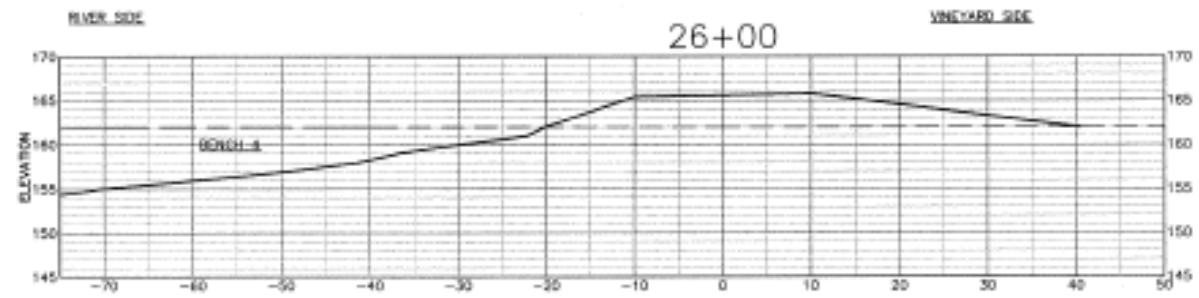
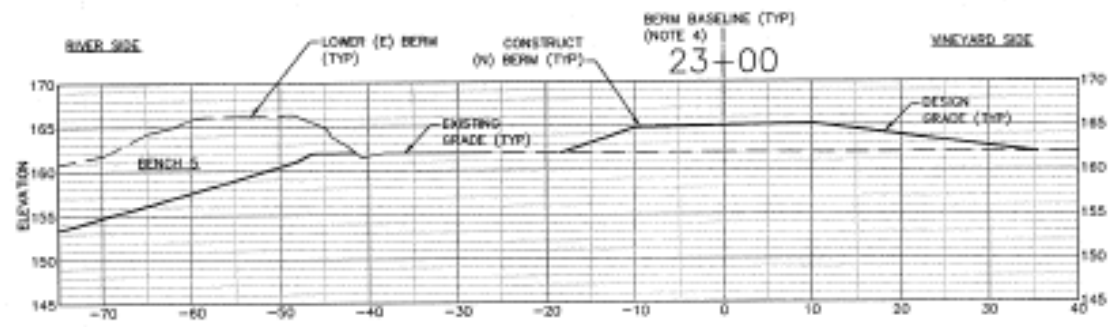

SHEET NOTES

1. SCALE FOR ALL GRADING SECTIONS IS 1"=10'.
2. SEE SHEET C10 FOR TYPICAL SECTIONS.
3. OVERCURE AS NEEDED TO CREATE LEVEL BERM FOUNDATION. SUBGRADE LIMITS NOT SHOWN ON THIS SHEET. SEE TYPICAL SECTIONS, SHEET C10.
4. STATION 0 ON THE CROSS-SECTION ALIGNS WITH THE (N) BERM BASELINE.



PWA
PUBLIC WORKS ASSOCIATION
FOR THE STATE OF CALIFORNIA
1100 CALIFORNIA STREET, SUITE 201
NAPA, CALIFORNIA 94559
PHONE: 707/255-1100

GRADING SECTIONS:
BERM STA 23+00 TO STA 28+00

PROJECT:
NAPA RIVER RESTORATION
RUTHERFORD REACH 3

NAPA COUNTY
DEPARTMENT OF PUBLIC WORKS
1195 Third St, Suite 201
Napa, CA 94559

DESIGNED BY K. BROWN J. BLUMBERG	DRAWN BY S. TOLLER
CHECKED BY A. BORGESINI C. GRIFFIN	
SCALE AS SHOWN	
DATE 8/20/01	
SHEET C14	

14 of 23

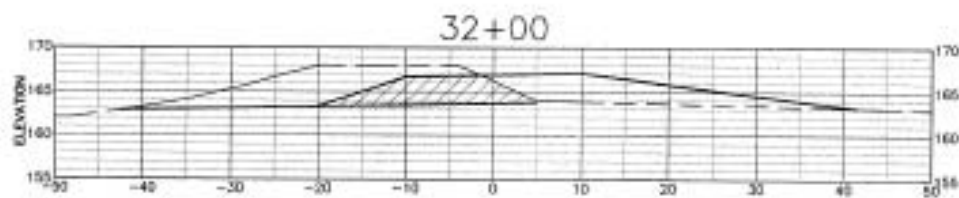
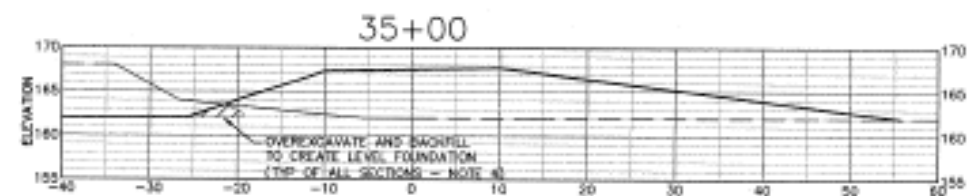
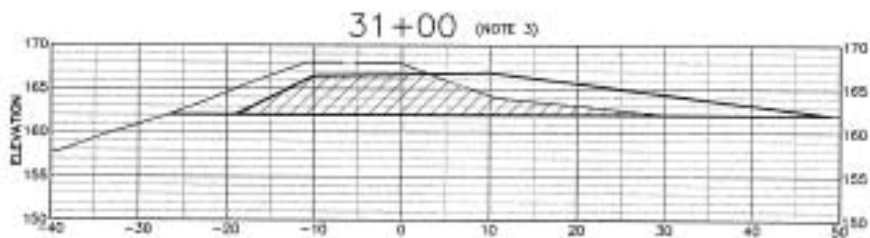
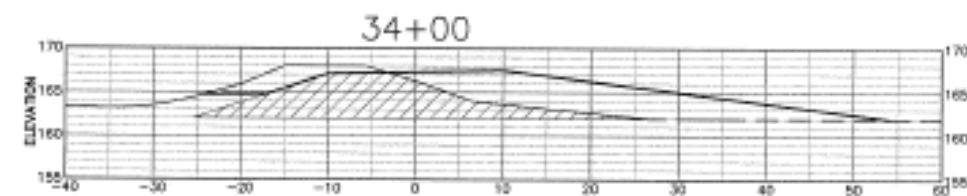
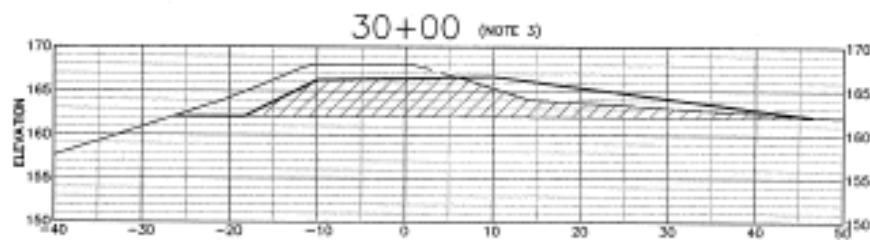
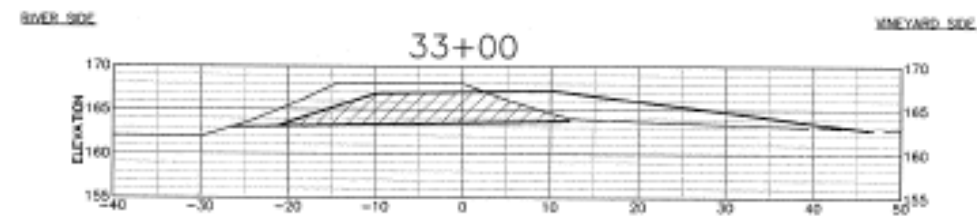
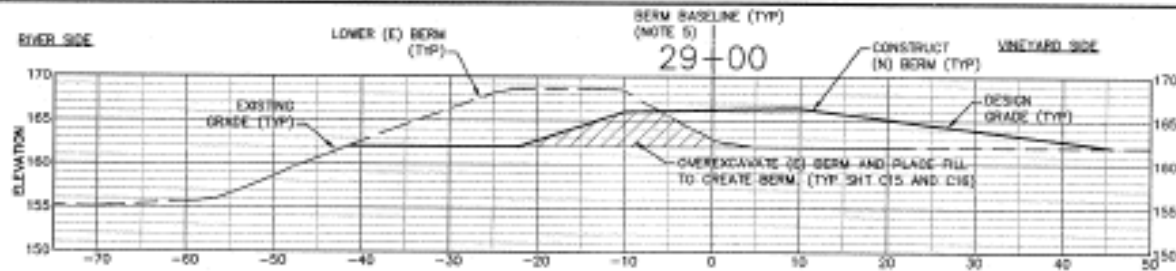

SHEET NOTES

1. SCALE FOR ALL GRADING SECTIONS IS 1"=10'.
2. SEE SHEET C10 FOR TYPICAL SECTIONS.
3. TYPICAL SECTION MODIFIED AT TOP OF CHANNEL BANK APPLIES TO STA 29+50 TO STA 31+00. BERM TOP WIDTH MAY BE REDUCED TO ENSURE RIVER SIDE BERM TOE IS 7 FT MIN FROM TOP OF RIVER BANK. SEE DETAIL 3, SHEET C10.
4. OVEREXCAVATE AS NEEDED TO CREATE LEVEL BERM FOUNDATION. SUBGRADE LIMITS NOT SHOWN ON THIS SHEET. SEE TYPICAL SECTIONS, SHEET C10.
5. STATION D ON THE CROSS-SECTION ALIGNS WITH THE (N) BERM BASELINE.



PREPARED BY: PWA
 SHEET TITLE: GRADING SECTIONS:
 BERM STA 29+00 TO STA 35+00
 PROJECT: NAPA RIVER RESTORATION
 RUTHERFORD REACH 3

PREPARED FOR:
 NAPA COUNTY
 DEPARTMENT OF PUBLIC WORKS
 1195 Third St, Suite 201
 Napa, CA 94559



APPROVED:
 DESIGNED: R. BROWN
 J. BLOMBERG
 DRAWN: B. STOLLER
 CHECKED: A. BORGOMONO
 DATE: 08/20/10
 SCALE: AS SHOWN
 SHEET: C15

C15

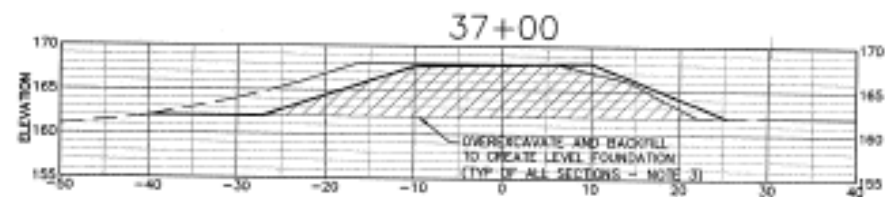
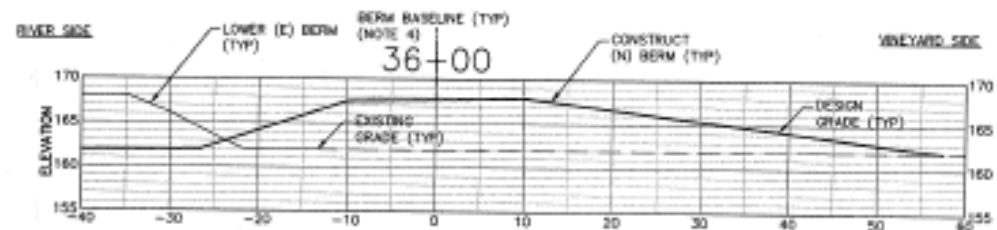

SHEET NOTES

1. SCALE FOR ALL GRADING SECTIONS IS 1"=10'.
2. SEE SHEET C10 FOR TYPICAL SECTIONS.
3. OVERCAVATE AS NEEDED TO CREATE LEVEL BERM FOUNDATION. SUBGRADE LIMITS NOT SHOWN ON THIS SHEET. SEE TYPICAL SECTIONS, SHEET C10.
4. STATION 0 ON THE CROSS-SECTION ALIGNS WITH THE (N) BERM BASELINE.



GRADING SECTIONS
STA. 36+00 TO 37+00
NAPA RIVER RESTORATION
RUTHERFORD REACH 3

NAPA COUNTY
DEPARTMENT OF PUBLIC WORKS
1195 Third St, Suite 201
Napa, CA 94559



DESIGNED	K. BROWN J. RUDBERG
DRAWN	S. STOLLER
CHECKED	A. BORODINOV G. FINE
SCALE	AS SHOWN
DATE	8/22/24
SHEET	

C16

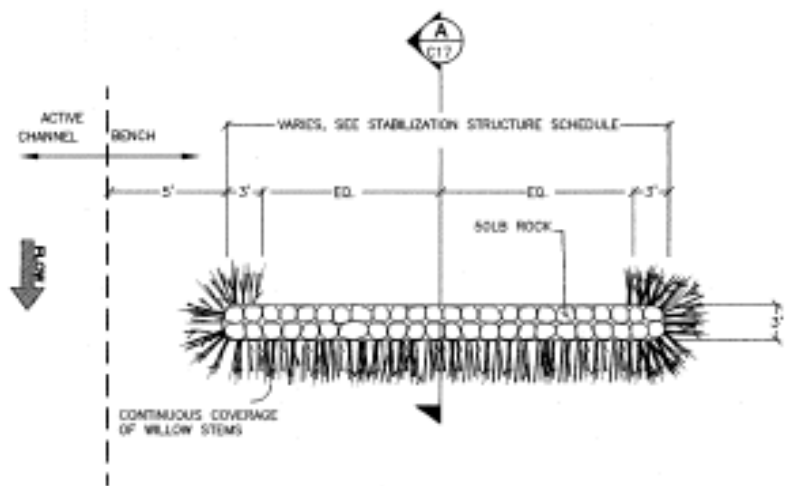

1
WILLOW BAFFLE PLAN
NTS
CO4, CO5, CO6

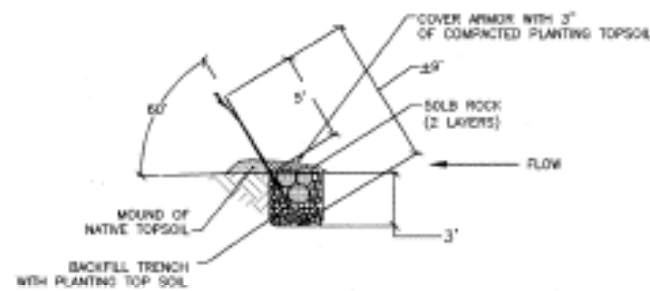

A
WILLOW BAFFLE SECTION
NTS

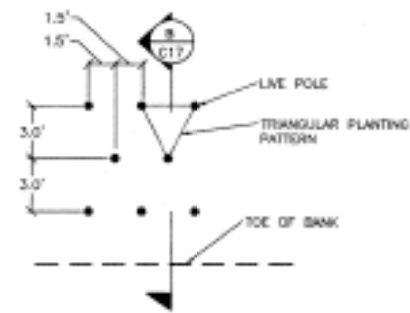

3
LIVE POLE PLANTING PLAN
NTS
CO4, CO5, CO6

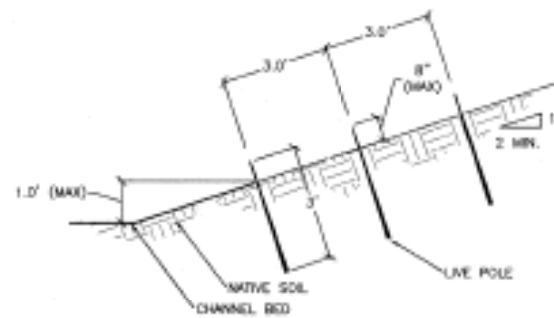

B
LIVE POLE PLANTING SECTION
NTS

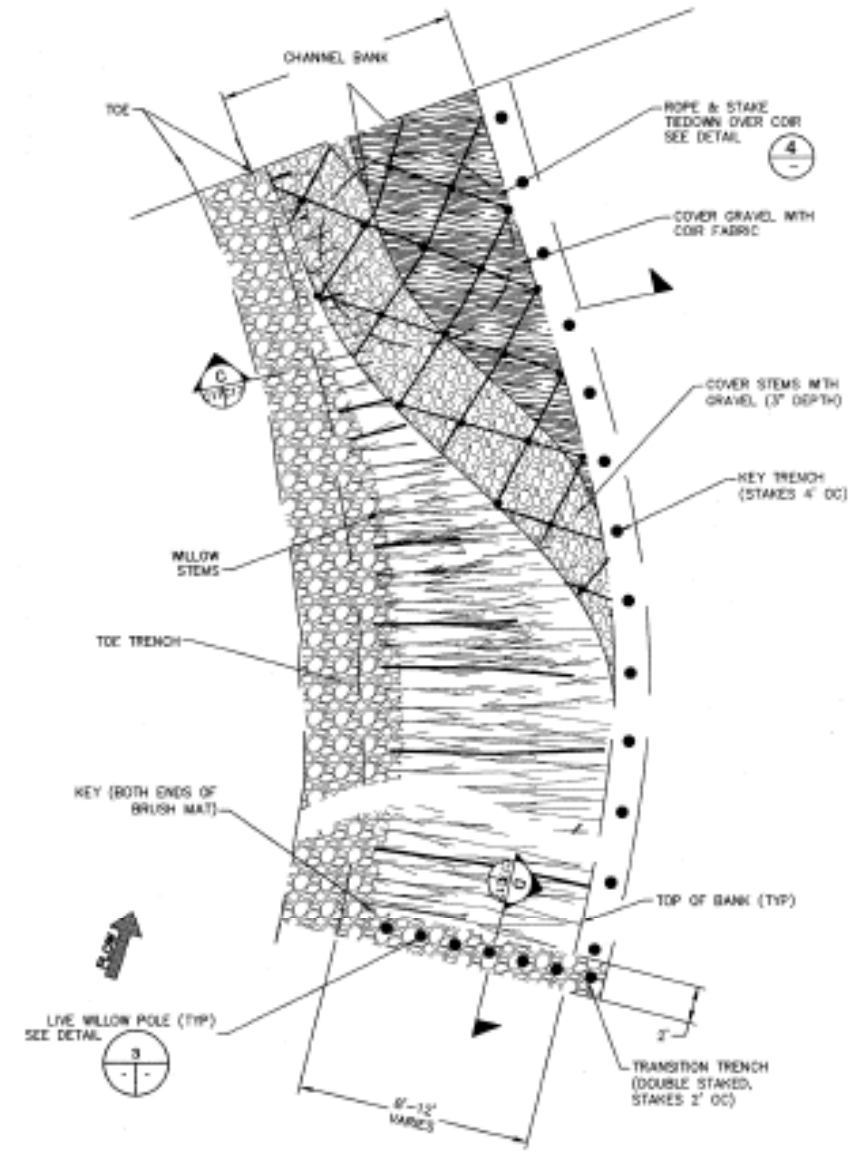

2
BRUSH MAT TYPICAL PLAN
NTS
CO4, CO5, CO6, CO9

TREATMENT	STATION RANGE	BANK	ELEVATION RANGE	LENGTH	TYPE
BENCH#1					
BRUSHMAT	STA 177+08 TO STA 178+80	RIGHT	147 TO 183	-	-
LARGE WOODY DEBRIS (TYPE B)	STA 178+85	-	-	25	2
WILLOW BAFFLE	STA 178+38	-	-	25	-
WILLOW BAFFLE	STA 173+08	-	-	25	-
LARGE WOODY DEBRIS	STA 174+48	-	-	1	1
BRUSHMAT	STA 178+80 TO STA 174+08	-	147 TO 182	-	-
BENCH#2					
BRUSHMAT	STA 173+80 TO STA 173+48	RIGHT	148 TO 150	-	-
WILLOW BAFFLE	STA 173+28	-	-	18	-
WILLOW BAFFLE	STA 173+08	-	-	15	-
LARGE WOODY DEBRIS	STA 171+88	-	-	1	1
BRUSHMAT	STA 171+88 TO STA 171+88	-	145 TO 150	-	-
BENCH#3					
BRUSHMAT	STA 171+48 TO STA 170+80	RIGHT	147 TO 151	-	-
WILLOW BAFFLE	STA 170+78	-	-	18	-
WILLOW BAFFLE	STA 170+68	-	-	15	-
WILLOW BAFFLE	STA 169+88	-	-	18	-
LARGE WOODY DEBRIS	STA 168+88	-	-	2	2
BRUSHMAT	STA 168+18 TO STA 168+50	-	145 TO 149	-	-
BENCH#4					
BRUSHMAT	STA 168+88 TO STA 168+88	LEFT	143 TO 150	-	-
WILLOW BAFFLE	STA 168+88	-	-	15	-
BRUSHMAT	STA 168+08 TO STA 168+50	-	144 TO VARIES	-	-
BENCH#5					
BRUSHMAT	STA 163+48 TO STA 163+10	LEFT	145 TO 150	-	-
WILLOW BAFFLE	STA 162+88	-	-	25	-
WILLOW BAFFLE	STA 162+88	-	-	28	-
BRUSHMAT	STA 161+38 TO STA 160+88	-	145 TO 152	-	-
LARGE WOODY DEBRIS	STA 161+38	-	-	-	-

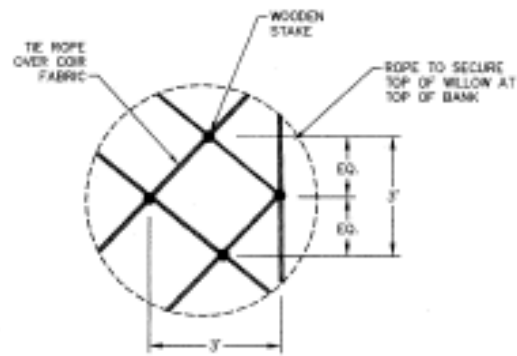

4
ROPE AND STAKE TIEDOWN DETAIL TYPICAL PLAN
NTS

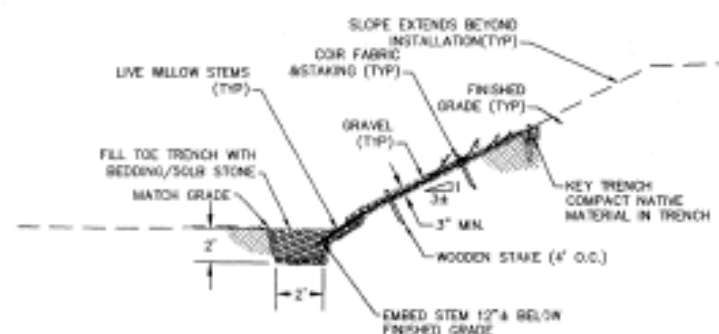

C
BRUSH MAT TYPICAL SECTION
NTS
CO4, CO5, CO6

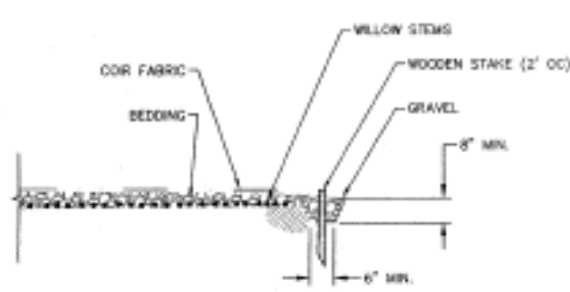

D
BRUSH MAT TRANSITION TRENCH TYPICAL CROSS SECTION
NTS



PROJECT: BIOTECHNICAL STABILIZATION DETAILS
NAPA RIVER RESTORATION RUTHERFORD REACH 3

PREPARED FOR: NAPA COUNTY DEPARTMENT OF PUBLIC WORKS
1195 Third St, Suite 201
Napa, CA 94559



DESIGNED BY: R. BROWN, J. BLONBERG
DRAWN BY: STANAGA
CHECKED BY: A. SORONGKO, CIVIL
SCALE: AS SHOWN
DATE: 03/20/19
SHEET: 17 OF 23



C17



APPROVED:

DESIGNED	A. BROWN
CHECKED	J. ROBBINS
DRAWN	S. TANAKA
PROJECT MANAGER	A. BORONOVIC
SCALE	AS SHOWN
DATE	07/20/20
SHEET	

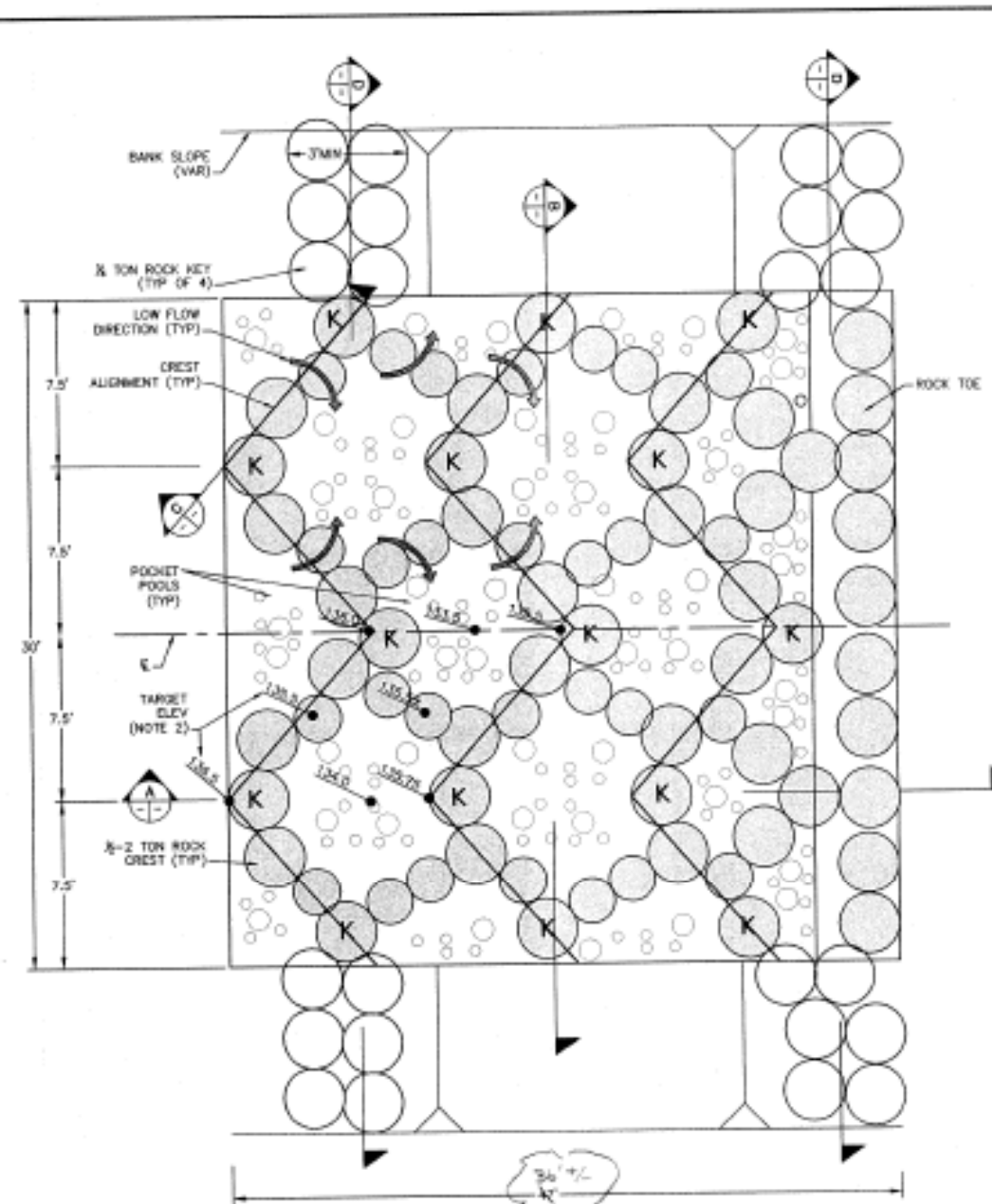

1 BOULDER GRADE CONTROL STRUCTURE PLAN VIEW

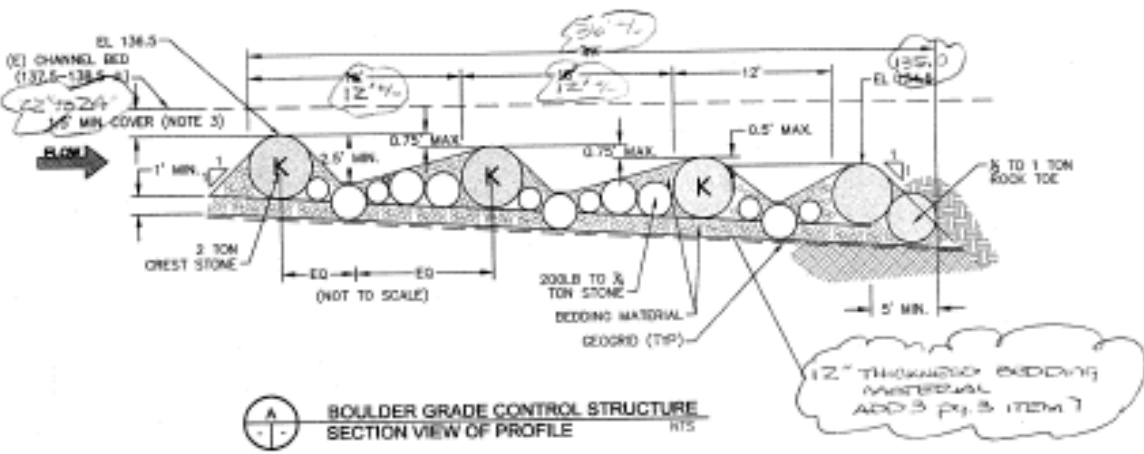

A BOULDER GRADE CONTROL STRUCTURE SECTION VIEW OF PROFILE

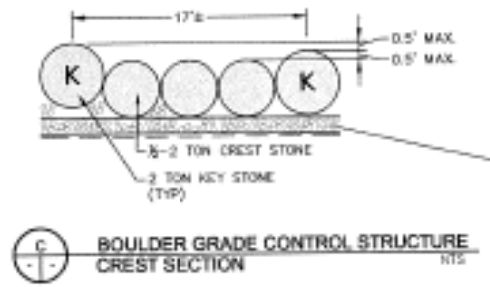

C BOULDER GRADE CONTROL STRUCTURE CREST SECTION

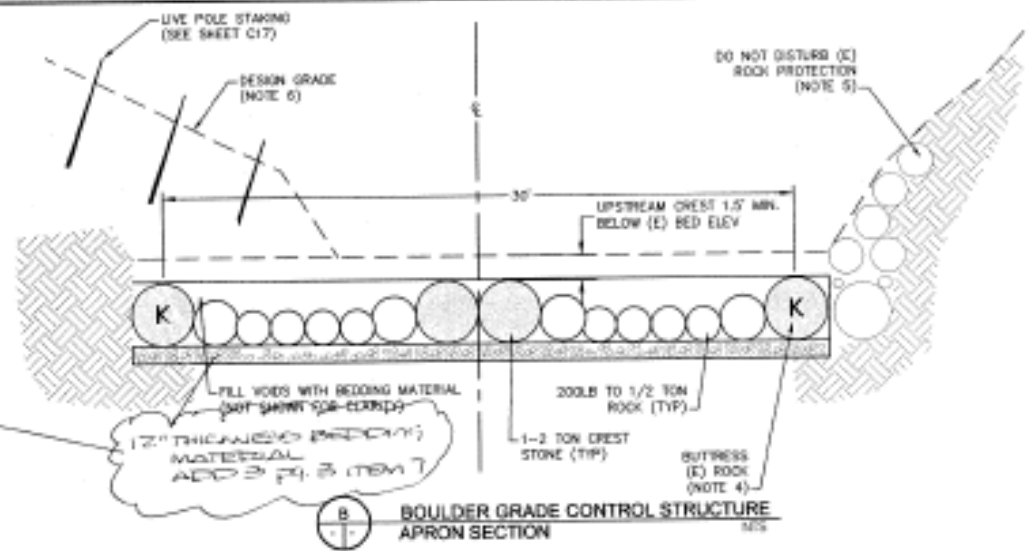

B BOULDER GRADE CONTROL STRUCTURE APRON SECTION

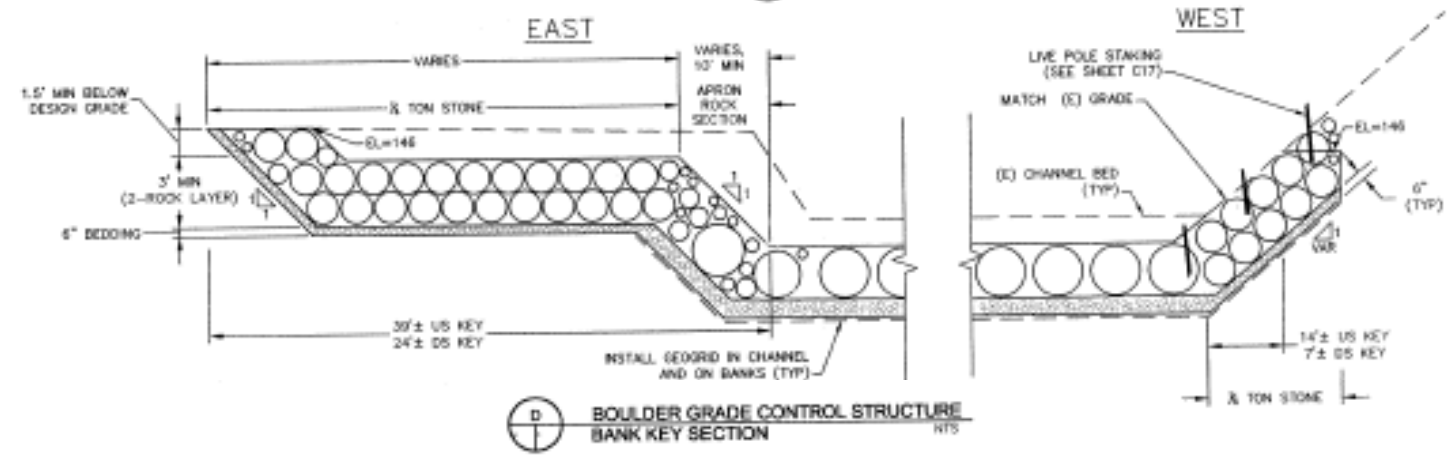

D BOULDER GRADE CONTROL STRUCTURE BANK KEY SECTION

SHEET NOTES

1. THE CONTRACTOR SHALL ANTICIPATE THAT RIVER FLOW DIVERSION AND/OR DEWATERING IS REQUIRED FOR INSTALLATION. COMPLY WITH ALL PERMIT REQUIREMENTS - SEE SPECS.
2. SELECT SPOT ELEVATIONS ARE PROVIDED AS GUIDANCE FOR STRUCTURE LAYOUT. USE SECTIONS TO DETERMINE REMAINING SPOT ELEVATIONS. THE STRUCTURE IS SYMMETRICAL ABOUT THE CENTERLINE. (NOTE THAT THE STRUCTURE IS NOT CENTERED ON THE CHANNEL THALWEG.)
3. THE DESIGN INTENT IS THAT THE STRUCTURE BE COMPLETELY BURIED FOLLOWING INSTALLATION, AND THAT THE UPSTREAM CREST IS APPROXIMATELY 1/2 INCHES BELOW THE CHANNEL THALWEG.
4. PRIOR TO BEGINNING CONSTRUCTION, STAKE THE CORNERS AND THE CENTERLINE OF THE APRON AND THE BANK KEY END POINTS IN THE FIELD. REPORT SURVEYED ELEVATIONS FOR EACH OF THESE POINTS TO THE OWNER'S REPRESENTATIVE. IF NEEDED ADJUST STRUCTURE LOCATION AND/OR DESIGN GRADE AS DIRECTED BY THE OWNER'S REPRESENTATIVE TO ACHIEVE THE DESIGN INTENT.
5. THE STRUCTURE SHALL BE KEYPED INTO EXISTING ROCK TOE PROTECTION ON THE WEST BANK. EXERCISE EXTREME CAUTION TO NOT DESTABILIZE THE BANK AND/OR ARMORING DURING INSTALLATION.
6. THE STRUCTURE EXTENDS BELOW THE GRADED BENCH ON THE EAST BANK. BACKFILL AND COMPACT THE DISTURBED EAST BANK TO MATCH DESIGN GRADES. MINIMIZE BANK DISTURBANCE TO THE EXTENT POSSIBLE.
7. CREST STONES (1/2-TON TO 2-TON) SHALL BE PLACED INDIVIDUALLY (CALTRANS METHOD A PLACEMENT). THE CONTRACTOR SHALL SELECT ROCK SIZE, ROTATE ITS PLACEMENT AND/OR EMBED IN THE BEDDING MATERIAL (8 INCHES MAXIMUM) AS NEEDED TO ACHIEVE THE VARIABLE DESIGN GRADES.

LEGEND



CONTROL POINT TABLE

STATION	NORTHING	EASTING
161+81	6442537.7	1934994.6
161+34	6442570.6	1934990.3

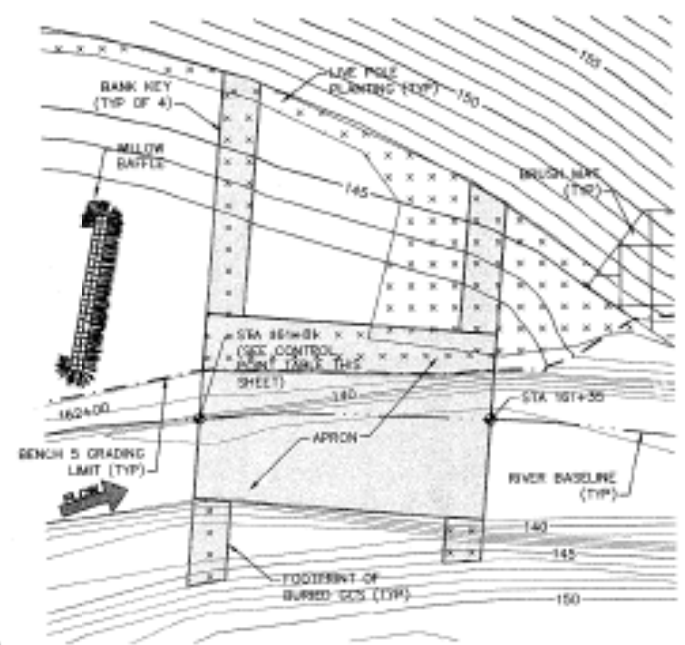

2 BOULDER GRADE CONTROL STRUCTURE PLAN VIEW

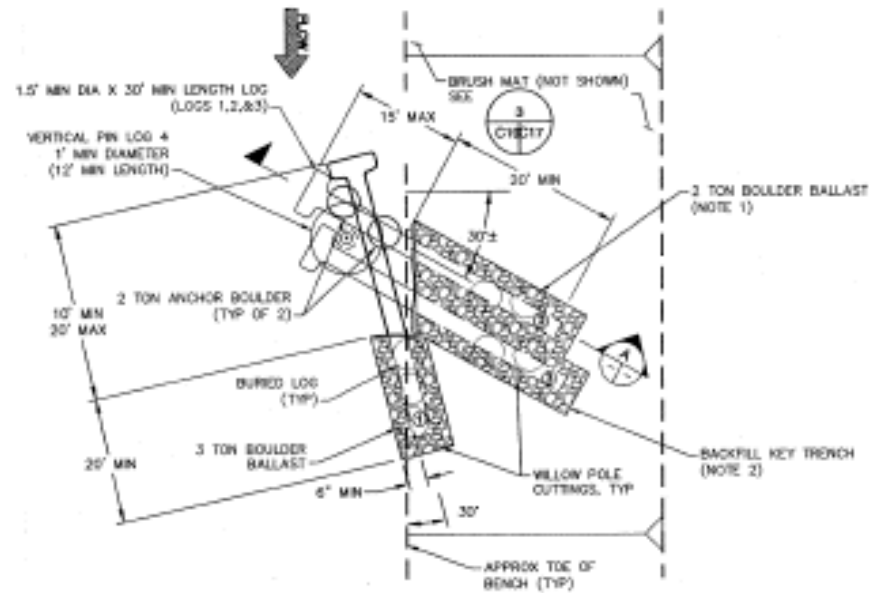

1
1" = 10'
LWD STRUCTURE-TYPE 1
PLAN
NTS
CO4, CO5, CO6

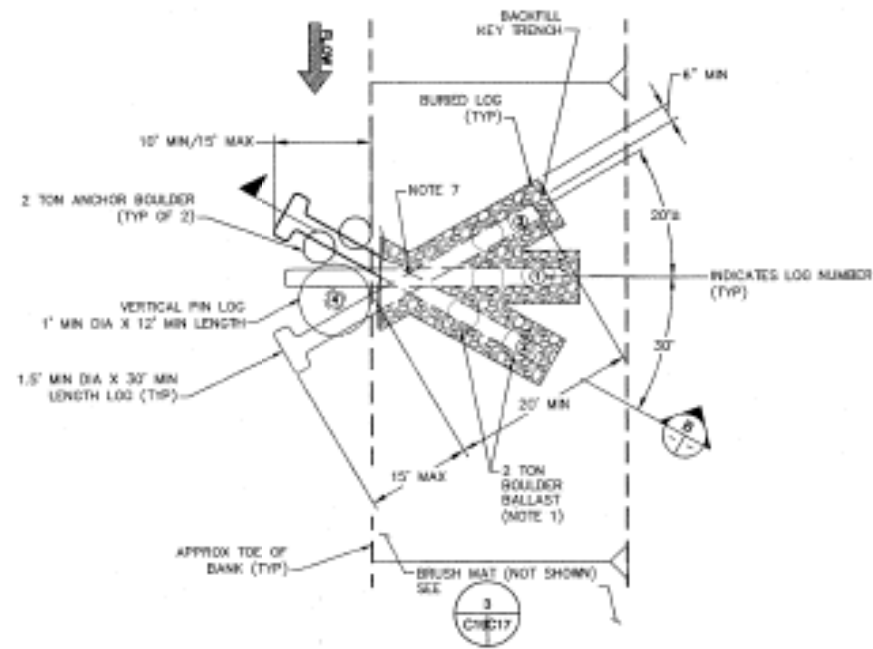

2
1" = 10'
LWD STRUCTURE-TYPE 2
PLAN
NTS
CO4, CO5, CO6

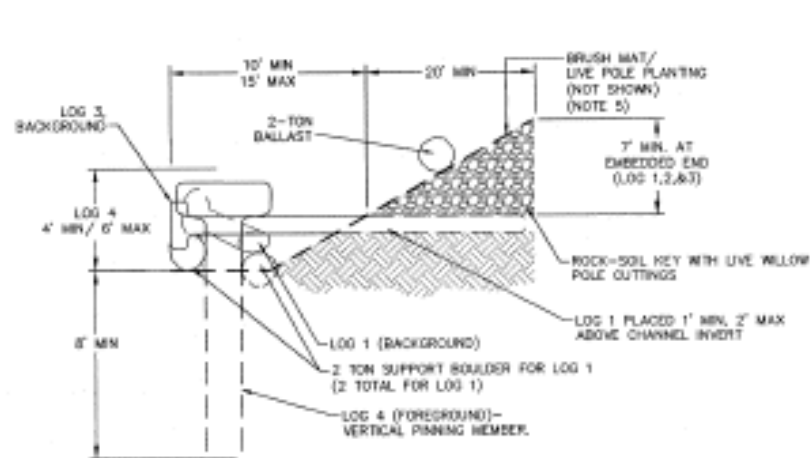

A
1" = 10'
LWD STRUCTURE, TYPE 1
SECTION
NTS

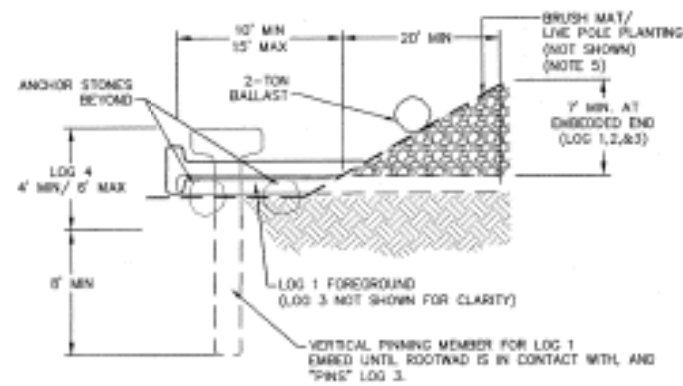

B
1" = 10'
LWD STRUCTURE, TYPE 2
SECTION AT LOG 2
NTS

SHEET NOTES

1. PRIOR TO INSTALLATION, FIELD STAKE LWD STRUCTURE LOCATIONS (LOG ENDPOINTS) FOR REVIEW BY THE OWNER'S REPRESENTATIVE. ALLOW 3 WORKING DAYS FOR REVIEW AND ADJUST STAKES AS DIRECTED.
2. LOGS SHALL BE PLACED IN THE PRESENCE OF THE OWNER'S REPRESENTATIVE. FIELD FIT AND ADJUST AS NEEDED TO CONFORM IRREGULAR LOGS TO MEAT DIMENSIONS SHOWN AND TO ACHIEVE LOG INTERLOCKING.
3. DETAIL SHOWS EMBEDMENT DEPTH ASSUMING THE LOG IS THE MINIMUM LENGTH SPECIFIED. IF LONGER LOGS ARE USED, INCREASE EMBEDMENT LENGTH AND DEPTH AS NEEDED TO MEET REQUIREMENTS SHOWN.
4. BACKFILL TRENCH WITH ROCK-SOIL MIX AND COMPACT TO 90% RC. STAKE THE ENDPOINTS OF THE BURIED LOG TO GUIDE BALLAST PLACEMENT.
5. INSTALL BRUSH MAT OVER FINISHED GRADE PER SHEET C17. INSTALL LIVE POLE PLANTING (PER SHEET C17) ON ANY PORTION OF THE DISTURBED BANK NOT COVERED WITH BRUSH MAT.
6. BALLAST BOULDERS CAN EITHER BE ONE 2-TON ROCK OR TWO 1-TON ROCKS AT CONTRACTOR'S OPTION. PLACE DIRECTLY OVER THE EMBEDDED LOG AND EMBED MIN 6 INCHES BELOW GRADE. FIELD LOCATE AS DIRECTED BY THE OWNER'S REPRESENTATIVE. TRIM HOLE IN COMPLETED BRUSH MAT AS NEEDED FOR ROCK PLACEMENT.
7. LOGS MAY BE NOTCHED (3" MAX) TO ACHIEVE ORIENTATION AND EMBEDMENT AS SHOWN.



PROJECT: LARGE WOODY DEBRIS (LWD) STRUCTURE DETAILS
NAPA RIVER RESTORATION RUTHERFORD REACH 3

NAPA COUNTY DEPARTMENT OF PUBLIC WORKS
1195 Third St, Suite 201
Napa, CA 94559



APPROVED:	
DESIGNED:	J. BROWN J. RUMBERG
DRAWN:	S. TAMARA
INCHPEP:	A. BORGONOV C. BIRD
SCALE:	AS SHOWN
DATE:	5/18/21
DRAWN BY:	



C19

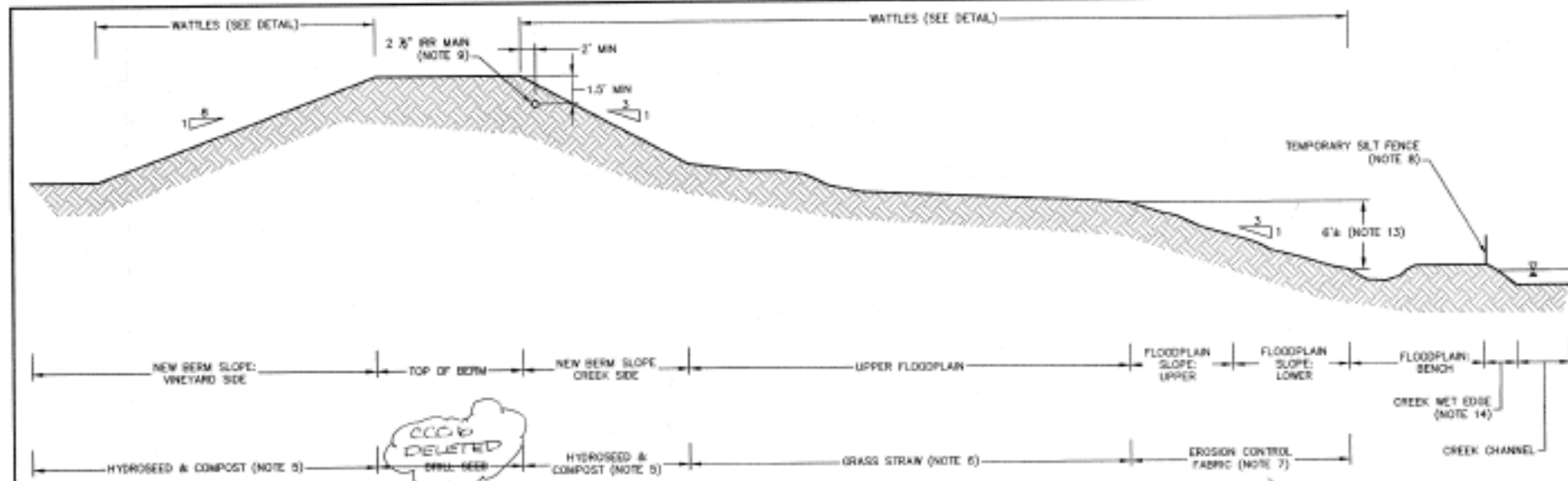

SEEDING & EROSION CONTROL PLAN
SCHEMATIC SECTION (NOTE 2)

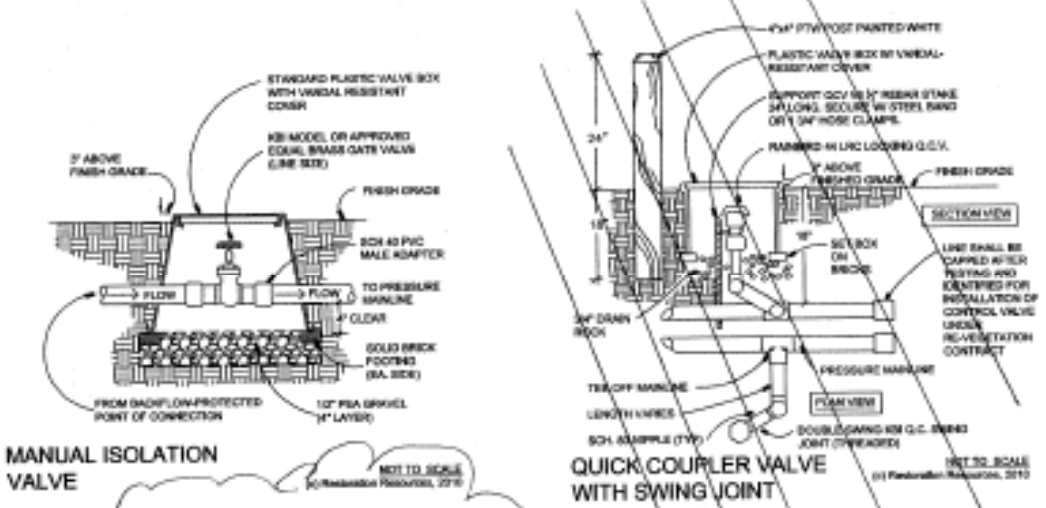

MANUAL ISOLATION VALVE

QUICK COUPLER VALVE WITH SWING JOINT

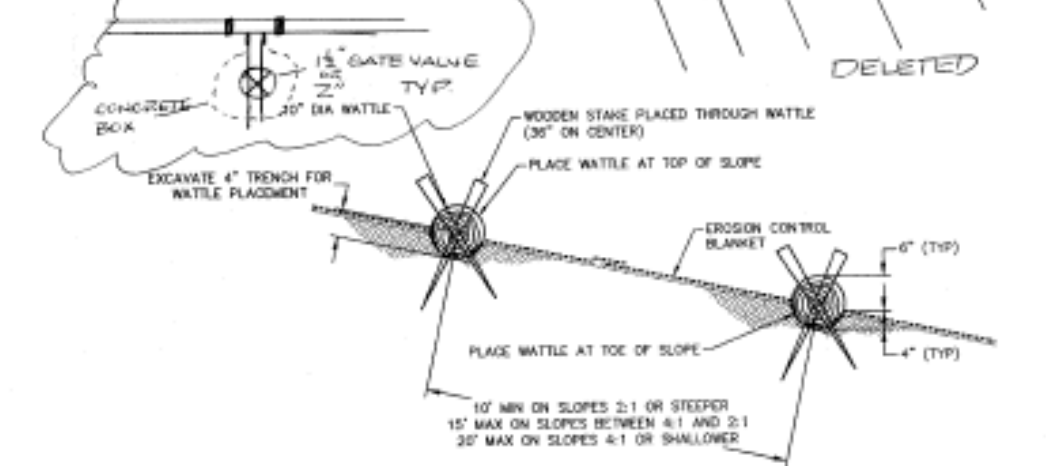

WATTLE DETAIL
SECTION VIEW

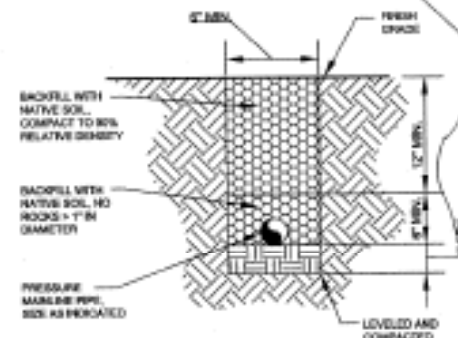

MAIN LINE TRENCHING

EROSION CONTROL SEEDING MIXES AND RATES (NOTE 11)

Lower Floodplain Bench	Acres:	0.8
Biological Name / Common Name	lbs / ac	Qty
Lepidosaphalepis / Creeping Wildrye	10	5

Floodplain Slope: Lower	Acres:	0.4
Biological Name / Common Name	lbs / ac	Qty
Holcus crachydenus / Meadow Baly	5	3
Lepidosaphalepis / Creeping Wildrye	5	3

Floodplain Slope: Upper	Acres:	0.5
Biological Name / Common Name	lbs / ac	Qty
Elymus glaucus / Blue Wildrye	8	4
Holcus crachydenus / Meadow Baly	8	4
Lepidosaphalepis / Creeping Wildrye	8	4

Upper Floodplain: Woodland	Acres:	2.8
Biological Name / Common Name	lbs / ac	Qty
Bromus catharticus / California Brome	8	16
Elymus glaucus / Blue Wildrye	8	16
Opuntia basilaris / Giant Plant	5	10
Holcus crachydenus / Meadow Baly	5	10
Nevea californica / California Milk	5	10
Vilfa microcarpa / Small Fescue	5	10

Berm Top & Access Route (See note 12)	Acres:	2.3
Biological Name / Common Name	lbs / ac	Qty
Holcus crachydenus / Meadow Baly	10	20.00
Vilfa microcarpa / Small Fescue	14	31.50

Created Berm Side Slope (Hydroseed)	Acres:	3.1
Biological Name / Common Name	lbs / ac	Qty
Bromus catharticus / California Brome	3	9.30
Elymus glaucus / Blue Wildrye	3	9.30
Elymus glaucus / Blue Wildrye	4	12.44
Opuntia basilaris / California Poppy	3	9.30
Festuca idahoensis / Idaho Fescue	3	9.30
Holcus crachydenus / Meadow Baly	4	12.44
Lepidosaphalepis / Creeping Wildrye	4	12.44
Taraxacum officinale / Tansy Clover	4	12.44
Vilfa microcarpa / Small Fescue	8	24.88

Staging Area (Grass Seeding)	Acres:	1.9
Biological Name / Common Name	lbs / ac	Qty
Triticum x Dymus 'Hygeon' / Straw Wheat	25	47.50
Strophanthe californica / California Poppy	4	7.60
Lepidosaphalepis / Creeping Wildrye	4	7.60
Taraxacum officinale / Tansy Clover	4	7.60

SHEET NOTES

- THIS SHEET SHOWS MINIMUM EROSION CONTROL MEASURES THAT ARE REQUIRED. INSTALL ADDITIONAL MEASURES AS NEEDED FOR SEDIMENT AND EROSION CONTROL AND SWPPP COMPLIANCE.
- THE SECTIONS SHOWS DESIGNATION OF SEEDING & EROSION CONTROL ZONES FOR GRADED AREAS. SET ALL DISTURBED AREAS PER TABLE. GENERALLY, THE WEST BANK ONLY INCLUDES ZONES DOWNSLOPE OF THE UPPER FLOODPLAIN (I.E. FLOODPLAIN SLOPE, BENCH, AND NET EDGE).
- UPON COMPLETION OF THE WORK RESTORE STAGING AREA(S) AND ACCESS ROUTES BY SEEDING (PER TABLES) AND APPLYING GRASS STRAW PER NOTE 6.
- SEE SEED MIX TABLES FOR SPECIES, QUANTITIES AND APPLICATION METHOD.
- APPLY SEED, HYDROSTRAW AND MYCORRHIZAE USING HYDROSEEDING MACHINE - SEE SPECS. AFTER HYDROSEEDING, APPLY UNIFORM 2-INCH MINIMUM LAYER OF ORGANIC COMPOST.
- APPLY CERTIFIED WEED-FREE NATIVE GRASS STRAW AT A RATE OF 1.5 TONS PER ACRE. APPLY BY HAND IN AREAS WHERE EXISTING VEGETATION OR TERRAIN PROHIBIT VEHICULAR ACCESS (TYPICALLY ON THE WEST BANK); STRAW MAY BE BLOWN ONTO THE SOIL SURFACE IN THOSE AREAS WHICH ARE ACCESSIBLE (TYPICALLY ON THE EAST BANK).
- INSTALL BIODEGRADABLE EROSION CONTROL FABRIC. SECURE ACCORDING TO MANUFACTURER'S RECOMMENDATIONS, AND THE SPECS (USE MOST STRINGENT REQUIREMENTS).
- INSTALL AND MAINTAIN SILT FENCE ALONG THE TOP OF THE ACTIVE CHANNEL BANK DURING BENCH GRADING. REMOVE BY OCTOBER 15TH.
- INSTALL IRRIGATION MANS WHERE SHOWN ON SHEETS R02 TO R04. IRRIGATION MANS SHALL BE LOCATED AT LEAST 2 FEET FROM DRIVABLE PORTION OF BERM AND WITH 18 INCHES MINIMUM COVER. BACKFILL TRENCH TO 90% RELATIVE COMPACTION.
- DISTURBED AREAS WILL BE PLANTED UNDER SEPARATE REVEGETATION CONTRACT. IN THE EVENT THAT CONTRACT SCHEDULES OVERLAP, COOPERATE AND COORDINATE WITH REVEGETATION CONTRACTOR AS NEEDED.
- UNLESS OTHERWISE NOTED, BROADCAST ALL SEED.
- DRILL SEED ON BERM TOP ONLY.
- PRIOR TO SEEDING, CONTRACTOR SHALL STAKE LIMITS OF FLOODPLAIN AND VERIFY WITH OWNER'S REPRESENTATIVE.
- WHERE DIRECTED BY THE OWNER'S REPRESENTATIVE, GRADE NET EDGE TO 3:1 PLACE LINE POLE PLANTING

PREPARED BY: **PWA**
PWA CONSULTANTS
1195 THIRD ST, SUITE 201
NAPA, CA 94559
TEL: 707.251.1195
WWW.PWACONSULTANTS.COM

PREPARED BY: **RESTORATION RESOURCES**
3000 CONCORD AVENUE
CONCORD, CA 94520
TEL: 925.309.2000
WWW.RESTORATIONRESOURCES.COM
CALIF. LICENSE # 40000

PROJECT: **EROSION CONTROL PLAN & IRRIGATION DETAILS**
NAPA RIVER RESTORATION
RUTHERFORD REACH 3

PREPARED FOR: **NAPA COUNTY DEPARTMENT OF PUBLIC WORKS**
1195 Third St, Suite 201
Napa, CA 94559

DATE: 8/20/20
SCALE: AS SHOWN
SHEET: **R01**
20 of 23

IRRIGATION LEGEND

SYMBOL	DESCRIPTION	MANUFACTURER / MODEL	DETAIL	REMARKS
◆	GRADE CONTROL VALVE	100000-01-000-1" (100000-01-000-1 1/2") 100000-01-000-2" (100000-01-000-2 1/2") 100000-01-000-3" (100000-01-000-3 1/2") ALL MODELS BY LATHROP CONTROL VALVE CO.	04-113	SEE AS SHOWN DETAIL IN STANDARD CODES OR OTHER PLANS. GRADE CONTROL VALVES SHALL BE INSTALLED AT THE POINT OF CHANGE IN GRADE. SEE DETAIL.
□	40' CHECK	100000-01-000-1" (100000-01-000-1 1/2") 100000-01-000-2" (100000-01-000-2 1/2") 100000-01-000-3" (100000-01-000-3 1/2")	04-113	VERIFY LOCATION IN FIELD.
□	40' CHECK	100000-01-000-1" (100000-01-000-1 1/2") 100000-01-000-2" (100000-01-000-2 1/2") 100000-01-000-3" (100000-01-000-3 1/2")	04-113	VERIFY LOCATION IN FIELD.
□	40' CHECK	100000-01-000-1" (100000-01-000-1 1/2") 100000-01-000-2" (100000-01-000-2 1/2") 100000-01-000-3" (100000-01-000-3 1/2")	04-113	VERIFY LOCATION IN FIELD.
◆	MANUAL ISOLATION VALVE (GATE VALVE)	100000-01-000-1" (100000-01-000-1 1/2") 100000-01-000-2" (100000-01-000-2 1/2") 100000-01-000-3" (100000-01-000-3 1/2")	04-113	VERIFY LOCATION IN FIELD.
○	40' CHECK	100000-01-000-1" (100000-01-000-1 1/2") 100000-01-000-2" (100000-01-000-2 1/2") 100000-01-000-3" (100000-01-000-3 1/2")	04-113	VERIFY LOCATION IN FIELD.
□	40' CHECK	100000-01-000-1" (100000-01-000-1 1/2") 100000-01-000-2" (100000-01-000-2 1/2") 100000-01-000-3" (100000-01-000-3 1/2")	04-113	VERIFY LOCATION IN FIELD.
□	40' CHECK	100000-01-000-1" (100000-01-000-1 1/2") 100000-01-000-2" (100000-01-000-2 1/2") 100000-01-000-3" (100000-01-000-3 1/2")	04-113	VERIFY LOCATION IN FIELD.
---	PVC MAINLINE PIPE (SIZE AS REQUIRED)	AS APPROVED		1" - 11/2" - PVC SCH 40 2" AND LARGER - PVC CLASS 200
---	PVC LATERAL PIPE	AS APPROVED		1/2" - 2" - PVC SCH 40
---	PVC SILENCE	AS APPROVED		THICKNESS SHOWN ON PLAN FOR LOCATION. VERIFY LEVEL ROAD FOR SCH 40.
---	40' CHECK	AS APPROVED		EACH SECTION NOT TO EXCEED 300' IN LENGTH. THE 40' CHECK SHALL BE INSTALLED AT THE POINT OF CHANGE IN GRADE. SEE DETAIL.
---	LATERAL PIPELINE	AS APPROVED		40' CHECKS SHALL BE INSTALLED AT THE POINT OF CHANGE IN GRADE. THE 40' CHECK SHALL BE INSTALLED AT THE POINT OF CHANGE IN GRADE. SEE DETAIL.

NOTES:

P.O.C. MINIMUM 55 PSI REQ. AT P.O.C.,
MINIMUM 1-1/2' PIPING

SHADED AREA IS UNDER THE REVEGETATION CONTRACT. WORK NOT TO BE INCLUDED UNDER EARTHWORK BID.

WORK NOT UNDER EARTHWORK CONTACT

LIMIT OF GRADING AND REVEGETATION WORK

CALLOUT MAP INLAY OF IRRIGATION AREA NOT SHOWN ON SHEET.

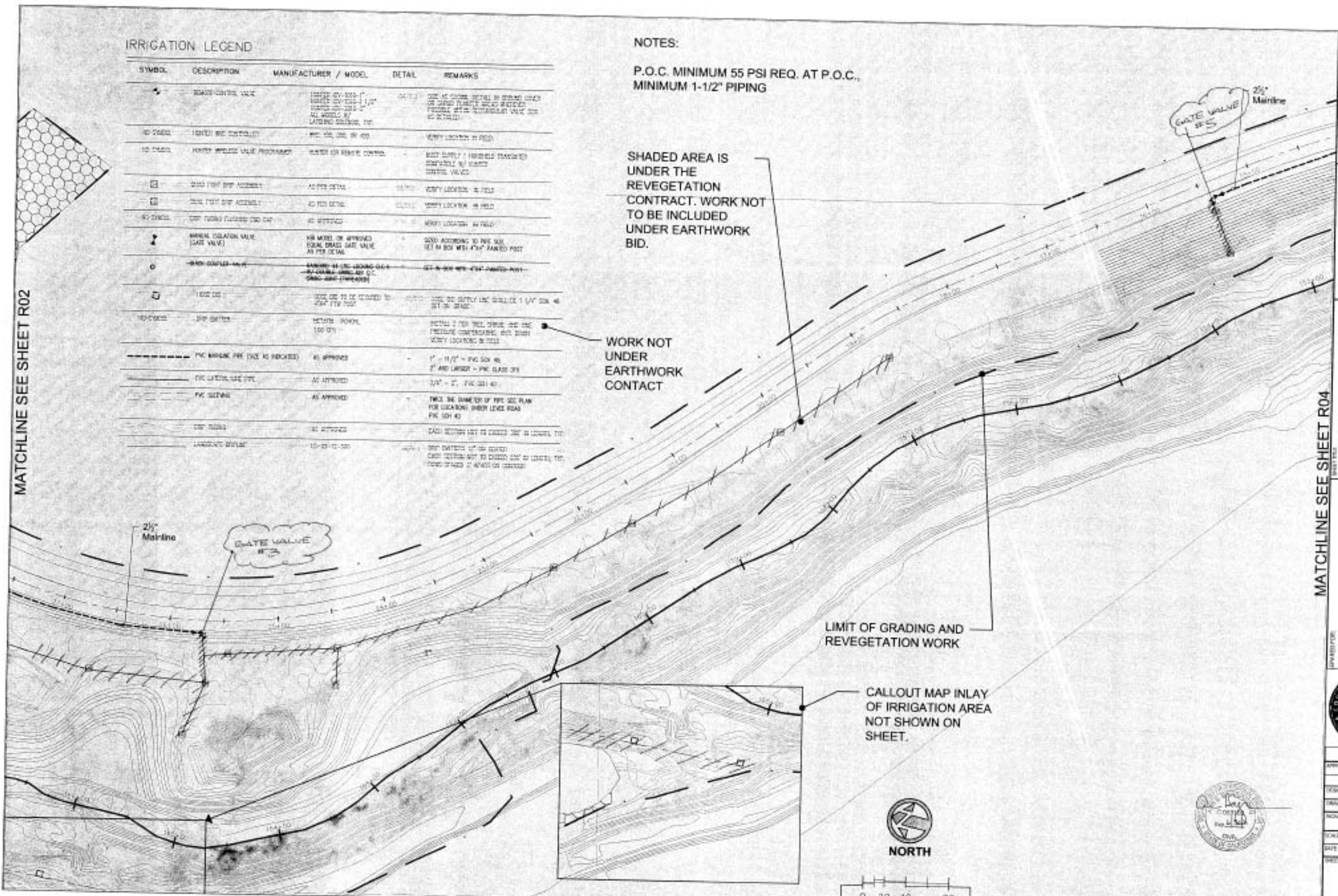

MATCHLINE SEE SHEET R02

MATCHLINE SEE SHEET R04

PREPARED BY: **OPWA**
 OPERATIONAL PLANNING & WATER ANALYSIS
 RESTORATION RESOURCES
 1195 THIRD ST., SUITE 201
 NAPA, CA 94959
 TEL: 707/255-1234
 FAX: 707/255-1235
 WWW.OPWA.COM

IRRIGATION PLAN -
 STA 152+82 to STA 166+69
 NAPA RIVER RESTORATION
 RUTHERFORD REACH 3

NAPA COUNTY
 DEPARTMENT OF PUBLIC WORKS
 1195 Third St., Suite 201
 Napa, CA 94959

APPROVED: _____
 DESIGNED BY: SMIT, J. PH.D.
 DRAWN: LAMAR
 CHECKED BY: SMIT, J. PH.D.
 SCALE: 1" = 50'
 DATE: 11 MAY 2010
 SHEET: **R03**
 22 OF 23

